

Door Retainers

The choice of door retainer hooks, door retainers catch plates and chains and lanyards etc. is driven by the application. We are pleased to give detailed advice, but the following points should be considered:

- Weld on or rivet/bolt on options are available
- Rivet/bolt on items can be fitted after final painting
- If repairs are necessary, removal or replacement of rivet/bolt on items is simple
- Steel doors/sides can be fitted with weld on or rivet/bolt on items.
- Ply/metal or GRP doors can only be fitted with rivet/bolt on items
- Materials available mild steel or stainless steel
- Finish, self colour, zinc plated or galvanised
- Options available for fitting to flat or corrugated sides
- Options available for fitting horizontally and vertically
- Options available for fitting to curtainsider vans and trailers
- Back plates are available to reduce snagging and improve aesthetics
- Several hook lengths are available & is a spring required?
- Door chains give greater flexibility when securing doors open but can cause snagging or dropped object issues in some industries
- Door hooks and catch plates need to be accurately fitted but are more secure and fold out of the way when not in use
- Other types and sizes of door chains, lanyards and carabine hooks are available upon request
- HD hooks with bends in them are also available
- For more information and dimensions please visit www.bloxwichdoorgear.com

Usage Examples



Containers



Horse Boxes



Trucks & Trailers

Model No BCP12770

Back Plate

Supplied in: Self colour polypropylene (black)

Use: With any rivet/bolt-on Bloxwich heavy duty door retainer hook, CAT160 or standard catch plate. Reduces snagging and potential damage of hooks and catches.

Weight: 1€

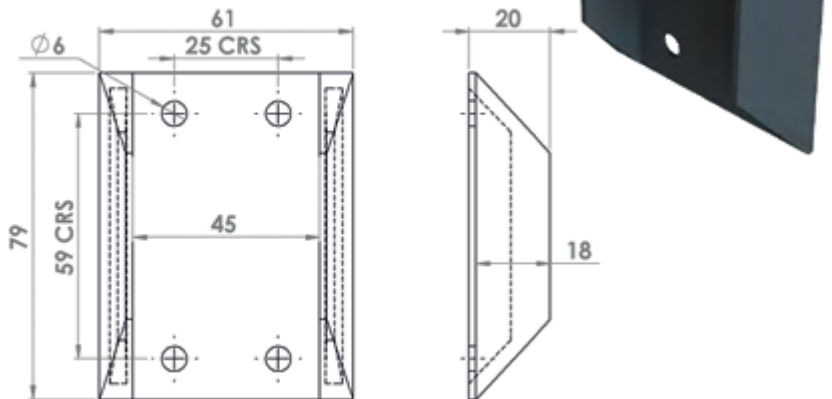

Model No BCSP15019

Door Retainer Hook

Supplied in: 304 stainless steel with self colour polypropylene (black) back plate BCP12770

Use: General purpose rivet/bolt-on door retainer hook, commonly used for holding open trailer and container doors. Can be used with any Bloxwich catch plate. Supplied with BCP12770 back plate to prevent snagging when mounted on exposed surfaces.

Weight: 97 g

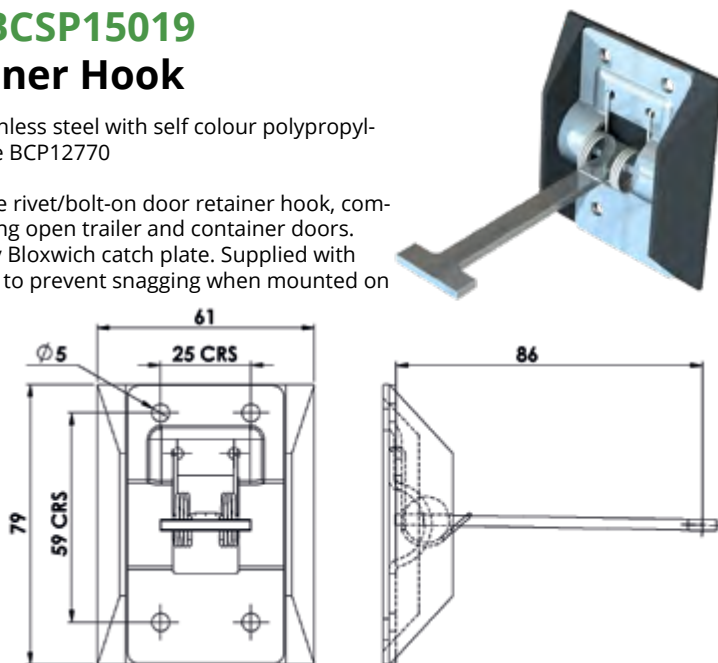

Model No CAT/BC(S)P

Heavy Duty Hook

Supplied in: Mild steel self colour, zinc plated or galvanised and 304 stainless steel

Use: General purpose rivet/bolt-on and weld on door retainer hooks, commonly used for holding open trailer and container doors. Can be used with any Bloxwich catch plate.

Others sizes and options available on request

Weight: See table



Model No	Variant	Rivet/Bolt-On or Weld On	"A"	Weight
CAT120-Z	Zinc plated	Rivet/Bolt-On	98	180 g
CAT120SS	Stainless steel	Rivet/Bolt-On	98	180 g
CAT130	Self colour, zinc plated or galvanised	Rivet/Bolt-On	148	207 g
CAT130SS	Stainless steel	Rivet/Bolt-On	148	207 g
CAT131	Self colour, zinc plated or galvanised	Weld-On	148	207 g
CAT 131SS	Stainless steel recommended for use with BCSP 14469	Weld-On	148	207 g
BCP25016	Self colour, zinc plated or galvanised	Rivet/Bolt-On	200	236 g
BCSP25016	Stainless steel	Rivet/Bolt-On	200	236 g
CAT130-L/G	Galvanised extended arm	Rivet/Bolt-On	300	275 g
CAT130-LSS	Stainless steel	Rivet/Bolt-On	300	275 g

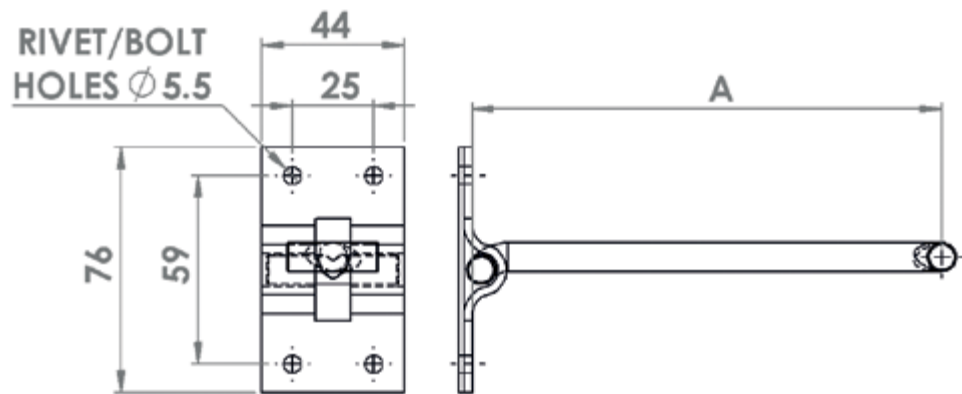

Model No BCSP23024/***

Heavy Duty Hook With Spring

Supplied in: 304 stainless steel plate and forged link with 302 stainless steel spring

Use: General purpose rivet/bolt on door retainer hook. Most often used to hold open trailer and container doors, also used in various other industries and with other types of doors. Can be used with any Bloxwich catch plate. Spring holds the hook against the mounting surface to eliminate unwanted movement, noise and possible wear but also allows the product to fitted vertically or horizontally. Forged heavy duty hook resists damage.

Alternatively used as folding supports for shelves, bars and counters.

Weight: See table

Model No	Variant	Rivet/Bolt-On or Weld On	"A"	Weight
BCSP23024/98	Stainless steel	Rivet/Bolt-On	98	142 g
BCSP23024/148	Stainless steel	Rivet/Bolt-On	148	165 g
BCSP23024/200	Stainless steel	Rivet/Bolt-On	200	192 g
BCSP23024/300	Stainless steel	Rivet/Bolt-On	300	242 g

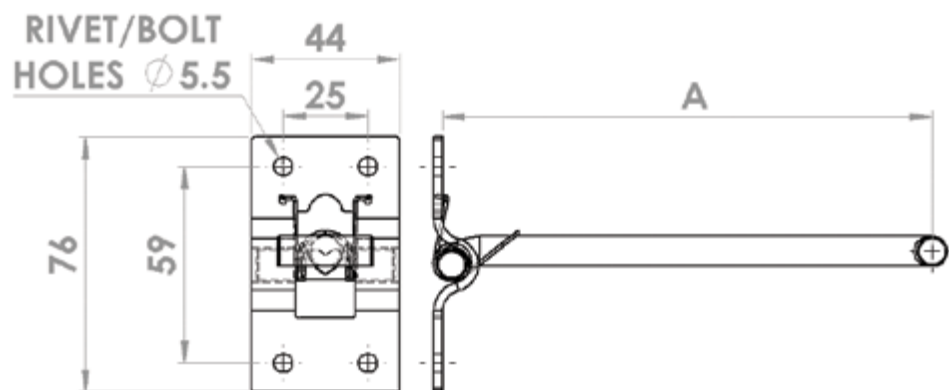

Model No BCP19220-012

Rope Door Holder

Supplied in: Mixed nylon rope Ø6.0 x 250mm overall length

Use: Standard shipping container rope door holder. Fitted to the door gear tubes on both doors. These are usually hooked onto half chain links or quick repair links or similar hooks welded onto the bottom side rails or side sheets of the containers to safely hold the doors in the fully open position (usually for use from ground level when containers are on trucks).

Weight: 10 g

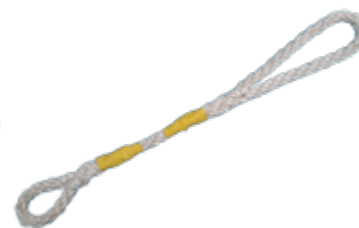
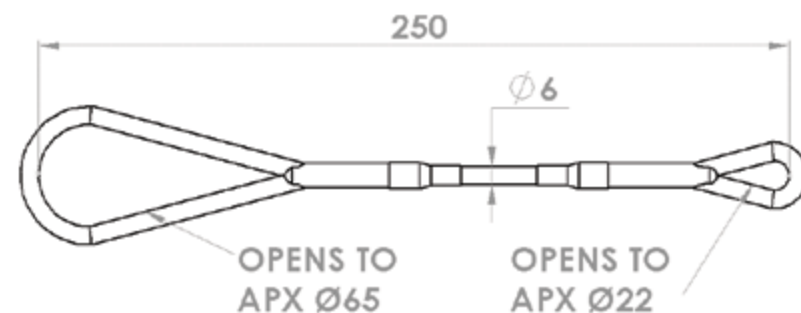

Model No BCP18014

Adjustable Door Retainer

Supplied in: White nylon with stainless steel adjuster screw

Use: General purpose rivet/bolt-on adjustable grip/force door retainer set, commonly used for holding open small doors. To adjust the grip/force required to engage/disengage simply turn the screw in or out.

Weight: 40 g

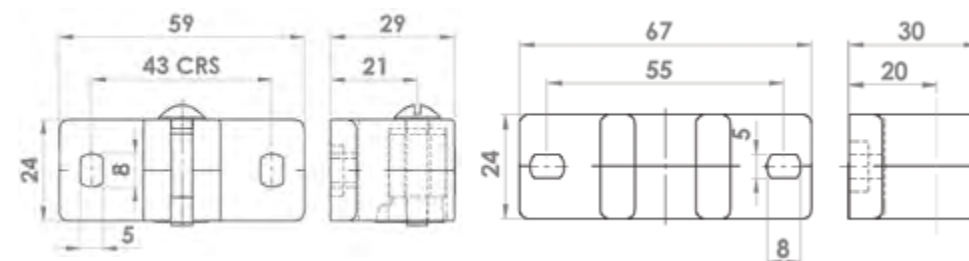

Model No BCP15058

Tag Line Pin Box / Recessed Catch Plate

Supplied in: Mild steel self colour pan with 304 stainless steel pin

Use: Recessed tag line point for offshore containers or recessed catch plate (when a chain and carabine are used e.g. BCSP16021 or BCSP16025).

Can be mounted in any orientation

Weight: 725 g

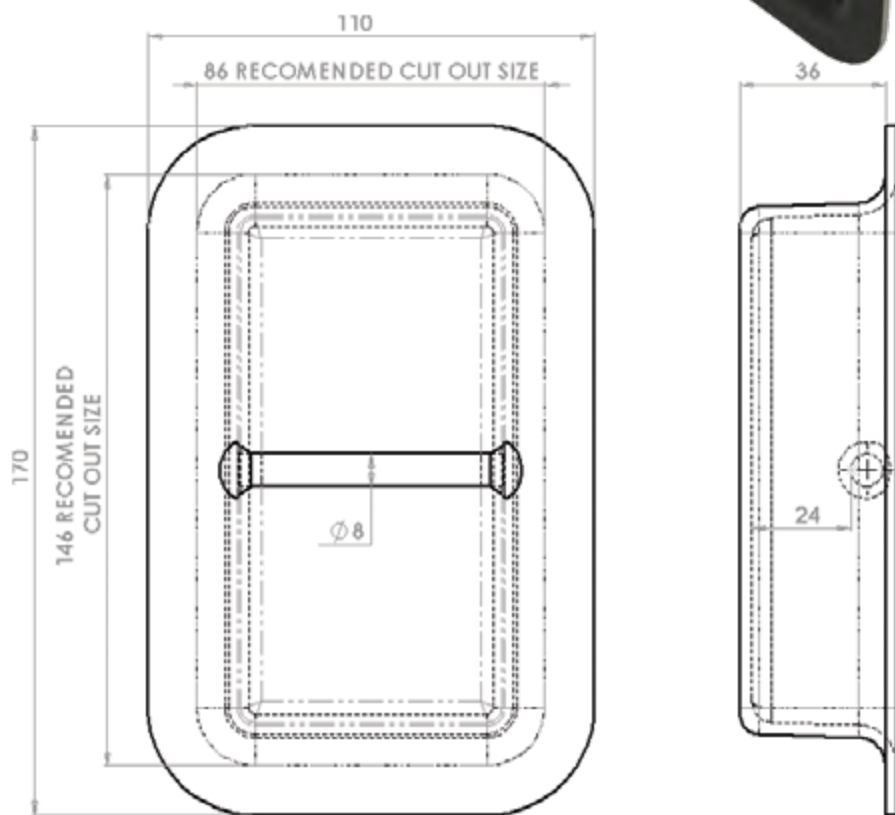

Model No BCP18023

Tag Line Pin Box / Recessed Catch Plate

Supplied in: Mild steel self colour pan with 304 stainless steel pin

Use: Recessed tag line point for offshore containers or recessed catch plate (when a chain and carabine are used e.g. BCSP16021 or BCSP16025).

Mount vertically

Weight: 685 g

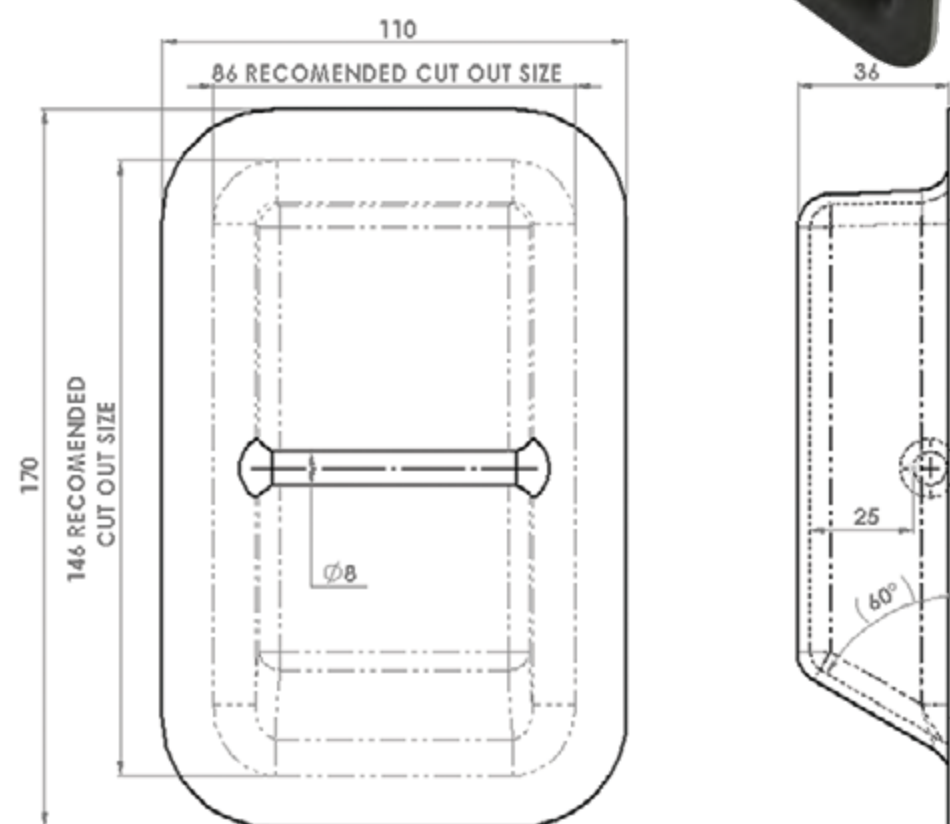

Model No 22376 Catch Plate

Supplied in: 304 stainless steel with self colour polypropylene (black) back plate BCP 12770

Use: Can be used with any Bloxwich door retainer hook, back plate reduces snagging and potential damage of catch plate.

Weight: 56 g

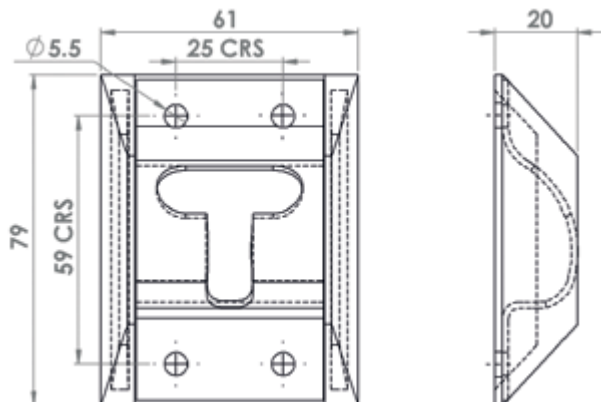

Model No 22376/2 Catch Plate With Spring

Supplied in: 304 stainless steel with PVC self colour (black) back plate BCP 12770

Use: Can be used with any Bloxwich door retainer hook, back plate reduces snagging and potential damage of standard catch plate with spring.

Weight: 92 g

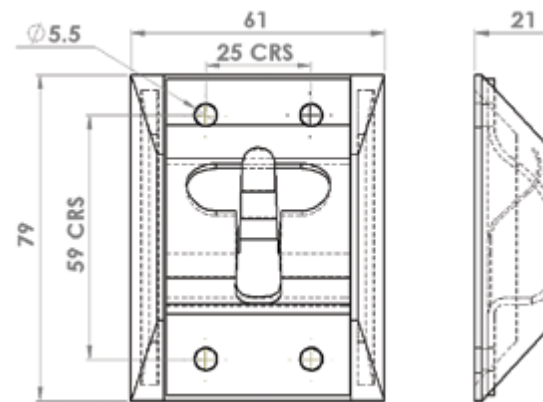

Model No 22376/1 Catch Plate

Supplied in: 304 stainless steel with PVC self colour (black) back plate BCP 12770

Use: Can be used with any Bloxwich door retainer hook, back plate reduces snagging and potential damage of catch plate.

Weight: 90 g

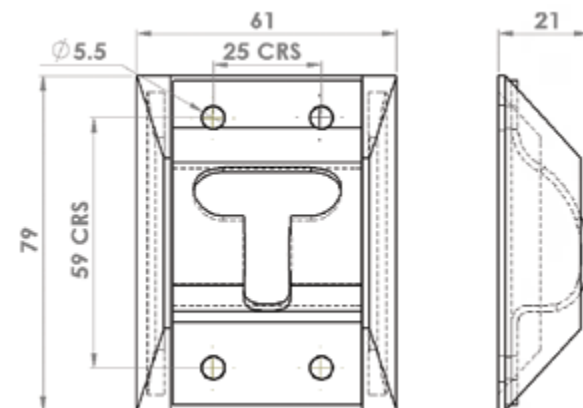

Model No BCSP15020 Standard Catch Plate With Spring

Supplied in: 304 stainless steel with PVC self colour (black) back plate

Use: Can be used with BCSP15019, back plate reduces snagging and potential damage of catch plate. Spring helps to keep the hook.

Weight:

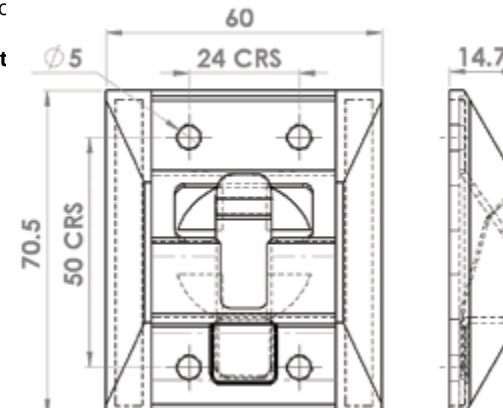

Model No CAT/CATSS Standard Catch Plates

Supplied in: Mild steel self colour, zinc plated or galvanised and 304 stainless steel

Use: Can be used with any Bloxwich door retainer hook

Weight: See table

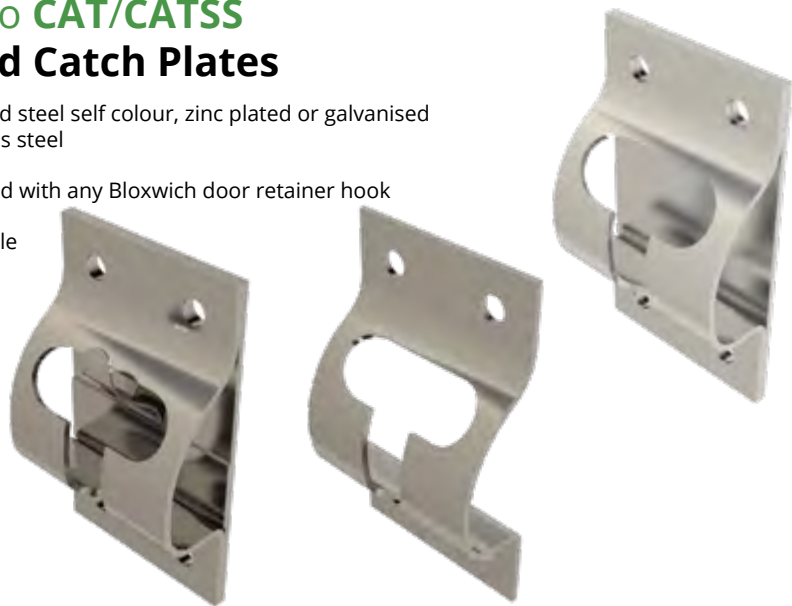

Model No	Variant	Options	Weight
CAT111	Self colour, zinc plated or galvanised	No spring	70 g
CAT111SS	Stainless steel	No spring	70 g
CAT121	Self colour, zinc plated or galvanised	With spring	70 g
CAT121SS	Stainless steel	With spring	70 g
BCSP12655	Stainless steel	Catch plate only	40 g

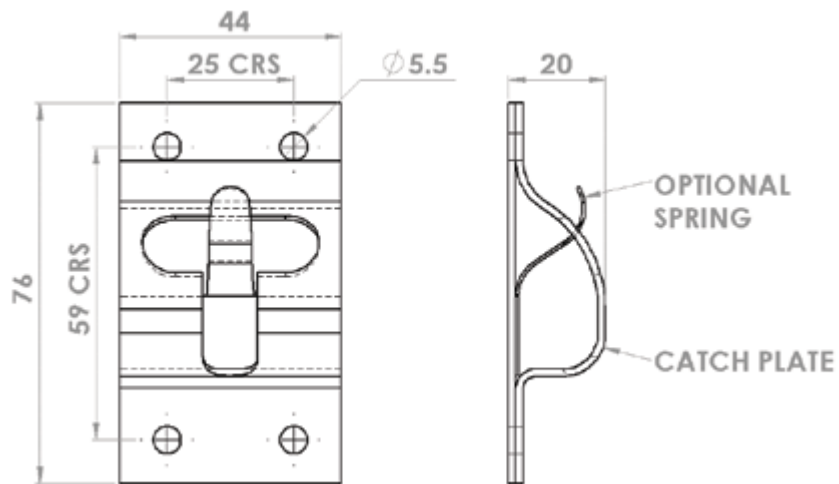

Model No CAT132 (Mild Steel) Model No CAT132SS (Stainless Steel)

Recessed Catch Plate (Weld On)

Supplied in: Mild steel self colour or 304 stainless steel

Use: Weld on recessed catch plate, commonly welded across corrugations

Weight: 45 g

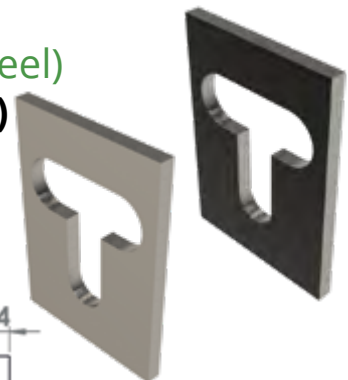
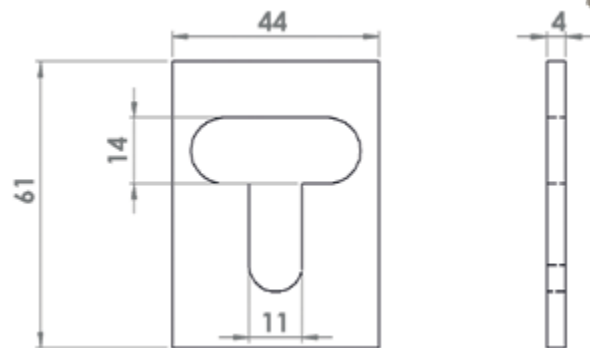

Container Corner Castings

ISO 1161 container corner castings are always available from our increased stocks. They are supplied individually or as end, upper, lower or complete sets.



+44 (0)1543 435 160

sales@bloxwichgroup.com

bloxwichgroup.com

bloxwichdoorgear.com



Model No CAT/BCSP Recessed Catch Plates

Supplied in: Mild steel self colour, zinc plated or galvanised

Use: Once recessed into a side sheet it can be used with any Bloxwich door retainer hook, security spring tab also fitted.

Weight: See table



Model No	Variant	Rivet/Bolt-On or Weld On	Options	Weight
CAT141	Self colour, zinc plated or galvanised	Rivet/Bolt-On	No spring	230 g
CAT141SS	Stainless steel	Rivet/Bolt-On	No spring	230 g
CAT142	Self colour, zinc plated or galvanised	Rivet/Bolt-On	With spring	230 g
BCP14469	Self colour, zinc plated or galvanised	Weld on	No spring	230 g
BCSP14469-S	Stainless steel	Weld on	No spring	230 g

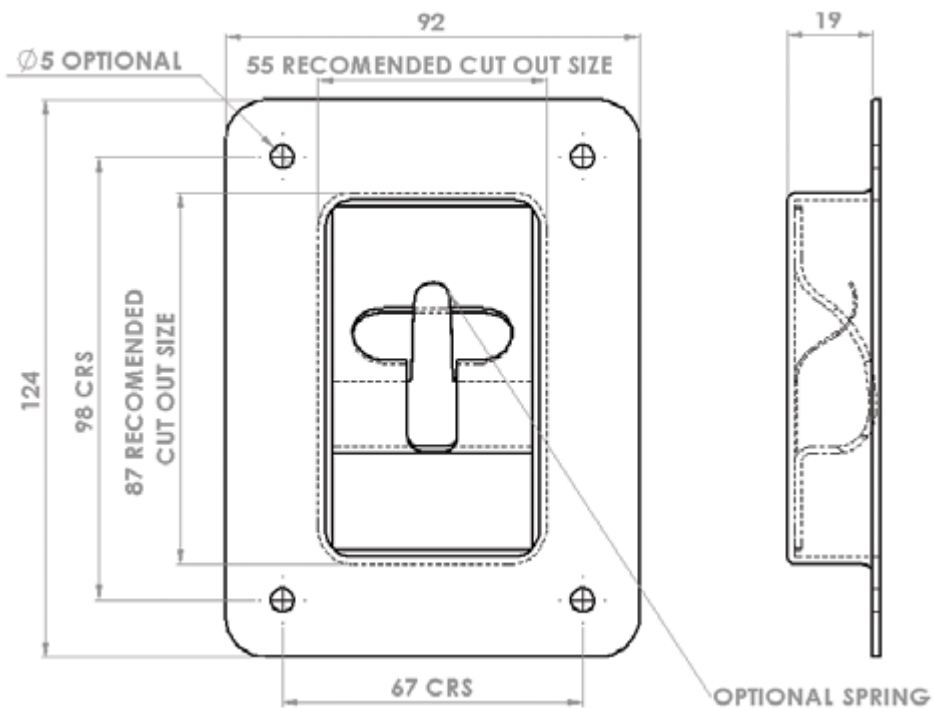

Model No BCP13094L & R Spring Loaded Door Retainer

Supplied in: Mild steel zinc plated

Use: Spring loaded door retainer commonly used on curtainsiders, 200mm of travel with rubber door stop. R version shown below, L version is symmetrically opposite.

Weight: 2.3 kg

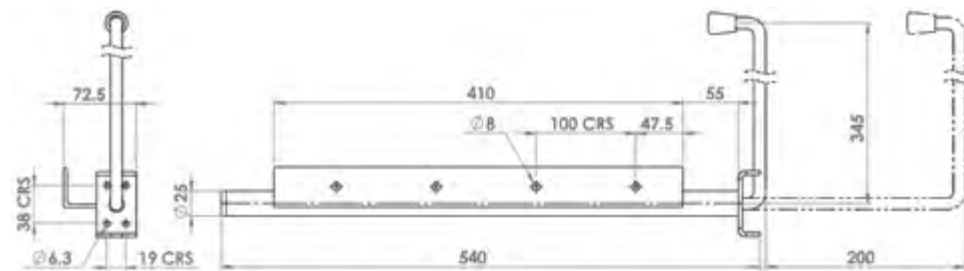
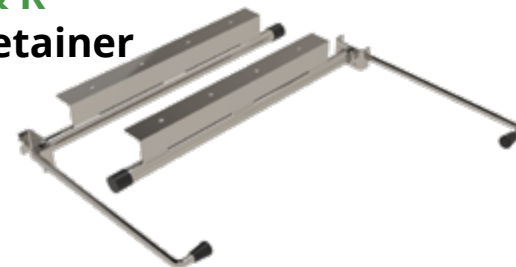

Model No BC(S)P123017

Trombone Type Extendable Door Retainer

Supplied in: Mild steel zinc plated or polished 304 stainless steel with 316 stainless steel internal retainer spring.

Use: Heavy duty internal spring-loaded door retainer to safely hold doors open, 300mm of travel with rubber door stop. Universal fitting.

Weight: 1.7 kg

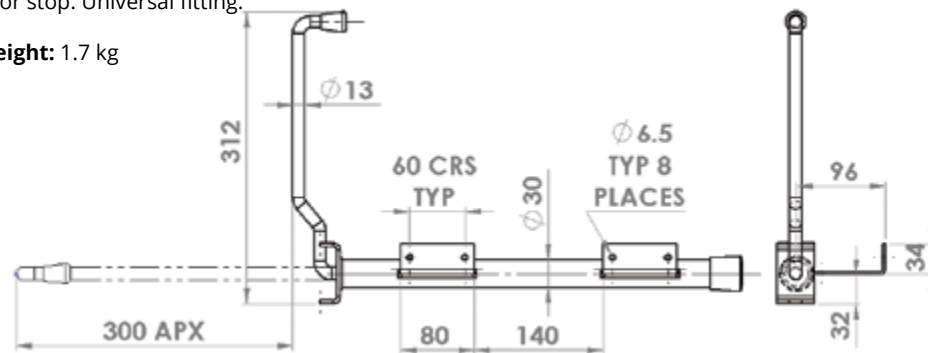
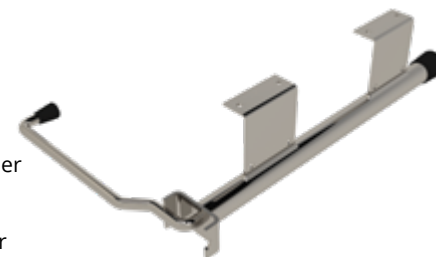

Model No BCSP16021/* Door Retainer Chain & Carabine

Supplied in: 316 stainless steel chain and carabine

Use: With BCP15058 tag line pin boxes. Can also be fitted through the door gear catch (modification may be required). Other sizes, materials and combinations available on request.

Several BCSP16021 link versions listed here but any number of links is possible, please contact us for details.

Carabine welded to chain. Chain can be cut and welded through BCP11354 or it can be bolted as shown.

Weight: See table

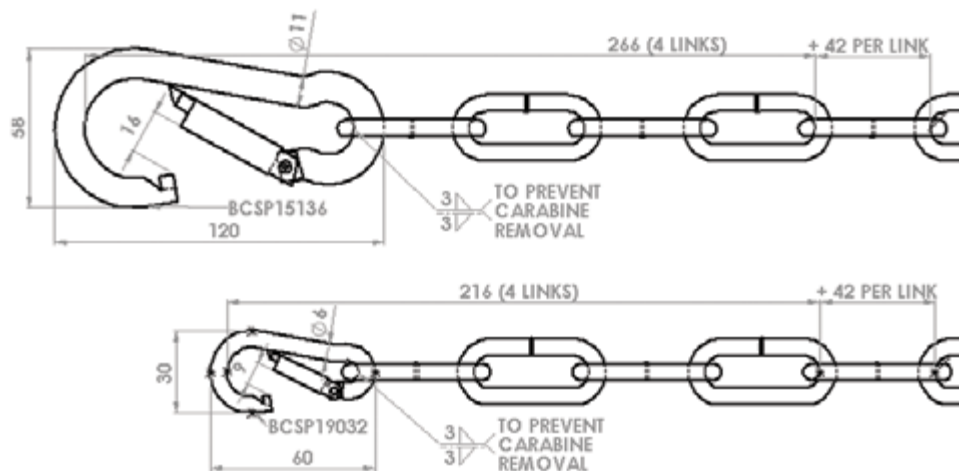

Carbine Ø x L	*	No of Links	Weight (4 links + 26 g per additional link)
Ø6 x 60	S	4/6/7/9 or 12	135 g
Ø11 x 120	E	4/6/7/9 or 12	270 g



Model No BCSP16023/** Door Chain & Carabine

MBL: 1300kg

Supplied in: 316 stainless steel

Use: For use as an additional safety measure to prevent doors bursting open on operators should the cargo be sitting against the inside of the doors on opening.

Other sizes, materials and combinations available on request. BCSP16023/12 12 link version listed here but any number of links is possible, please contact us for details.

150mm gap on opening suggested. Carabine welded to chain

** Is the number of links required. Each extra link adds 28mm to the length

Weight: 870 g (12 links as shown)

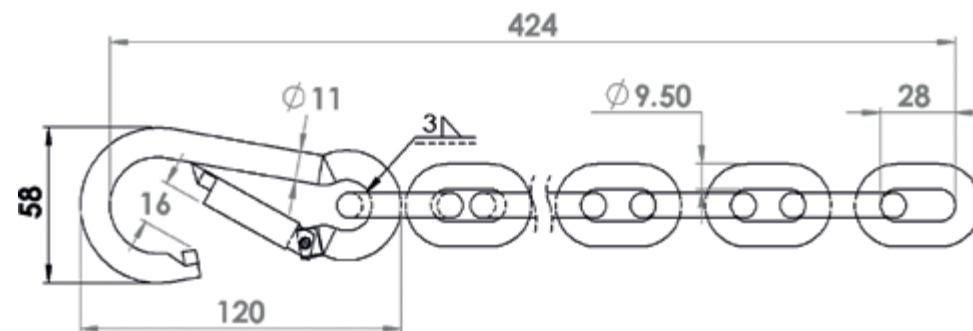

Door Secondary Securing Chain & Carabine

Weight: 305 g (7 links as shown)

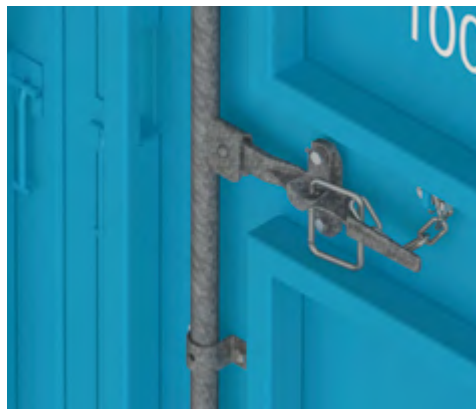
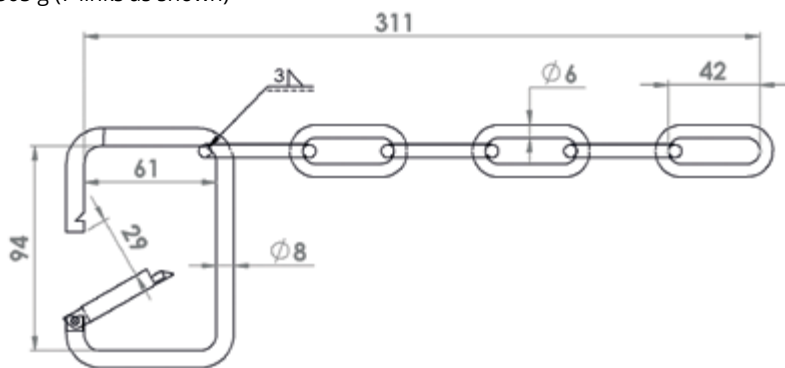

Lanyards

** Is the length required in mm (centre to centre).

Weight: Wire 34g/m + carbine

Bolt Ø	*	Length	Use with Handle	Carbine Ø x L	*	Carbine Weight	Ferrule	*
M8	A	Exact length in mm (soft eyes, cen- tre to centre (see below image))	None				Aluminium	A
M10	B		Small Forged, Pressed or D grip	Ø6 x 60	S	27 g	Copper	C
				Ø6 x 60 c/w eyelet	SE	29 g		
			Forged	Ø11 x 120	E	170 g	Stainless	S
				Ø11 x 120 c/w eyelet	EE	173 g		

*When ordering, please add the above 'characters' to the part number to indicate required condition, e.g. BCSP17024A500SES indicates soft eyes to suit M8 bolts, 500mm long with a Ø6 x 60 carbine hook c/w eyelet and stainless steel ferrules.

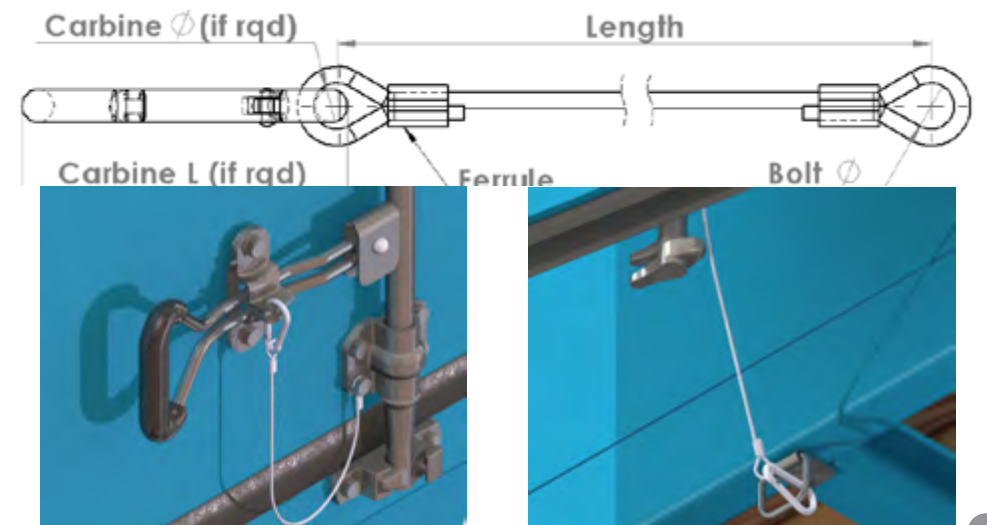

Model No BCP17025 (Mild Steel) Model No BCSP17025 (Stainless Steel)

Door Safety Chain

Supplied in: Mild steel zinc plated or stainless steel

Use: As an additional safety measure to prevent doors bursting open and cargo falling from height on personnel should the cargo be sitting against the inside of the doors on opening.

Is also a secondary door securing device and alternative to tie wraps or customs seals etc

Weight: See table

Finish	*	For Door Handle	Carbine Ø x L	*	Weight
Zinc	Z	D Grip or Pressed Handle	Ø6 x 60	S	510 g
Polished	V	Forged Handle	Ø11 x 120	E	840 g

*When ordering, please add the above 'characters' to the part number to indicate required condition, e.g. BCP17025ZS indicates zinc plated with carbine hooks suitable for D grip or pressed handle.

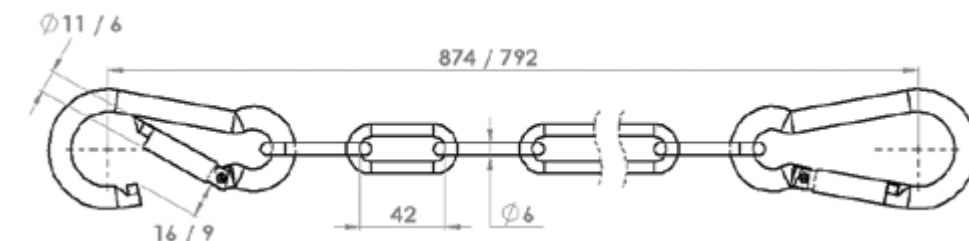

Model No BCSP19076 Carbine Hook With Retaining Wire & Tab

Supplied in: 316 stainless steel

Use: General purpose Ø8mm carbine hook with eyelet, retaining wire (Ø3 x apx 200mm long) & tab for bolting in place

Weight: 110 g

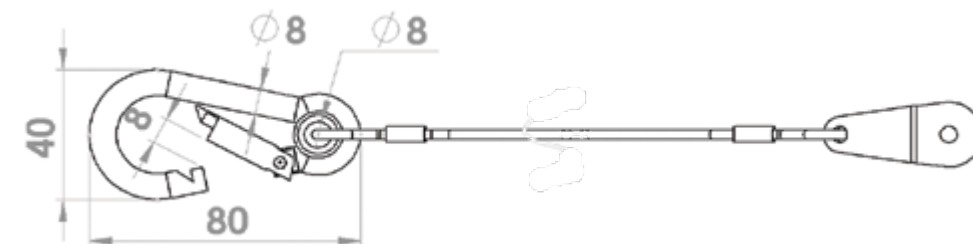

Model No BCP23009/10/11 Lynch Pin & Chain Assembly

Supplied in: Mild steel zinc plated

Use: Ø6, 8 or 10mm lynch pins with a length of Ø3 x 21 chain to secure them in place and ensure they don't get lost. Other sizes, materials and combinations available on request.

BCP23009, 10 & 11/10 & 11 link versions listed here but any number of links is possible, please contact us for details.

Weight: 58 g/ 67 g/ 80 g + 3.5 g per additional link

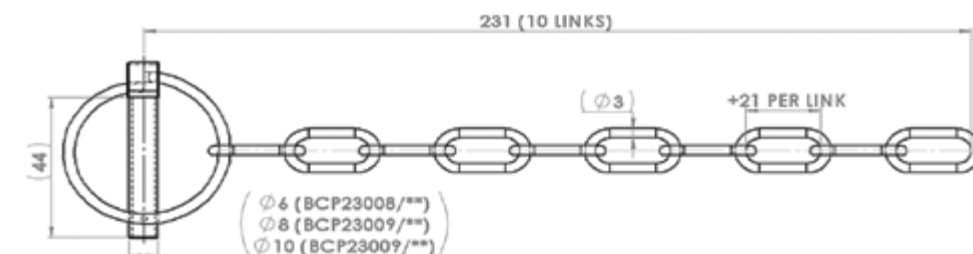

Model No BCP (Mild Steel) Model No BCSP (Stainless Steel)

Chain

Supplied in: Mild steel zinc plated or galvanised and 304 stainless steel

Use: General purpose chain commonly used for retaining doors, as secondary retention measures or for securing caps or plugs to equipment

Other sizes available upon request please contact us for details

Weight: See table

Part No	Finish	Ø x L	Weight
BCP23008Z	Zinc	Ø3 x 21 chain	190 g/m
BCP15137Z	Zinc	Ø6 x 42 long link chain	630 g/m
BCP15137G	Galvanised	Ø6 x 42 long link chain	630 g/m
BCSP15137	Polished	Ø6 x 42 long link chain	630 g/m

Model No BCP (Mild Steel) Model No BCSP (Stainless)

Quick Repair Links

Supplied in: Mild steel zinc plated or 316 stainless steel

Use: G Used to join two chains together or simply as a fastener for every day use to attach chain and lanyards etc. Open and close by simply rotating the locking screw nut.

Other sizes available upon request please contact us for details

Weight: See table

Part No	Finish	Ø x L	H	O	Weight
BCSP18026	Zinc plated	Ø6 x 45	26	7.5	30 g
BCP18025	Zinc plated	Ø8 x 59	34	9.5	70 g
BCSP18025	Polished 316SS	Ø8 x 59	34	9.5	70 g

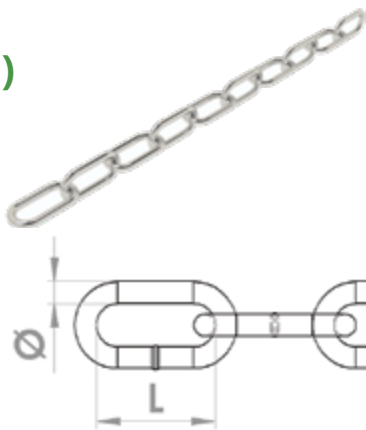

Combining SolidWorks Professional, Visualize, Composer, 3D printing, Adobe Photoshop and InDesign software etc with decades of experience in DNV & ISO container design, test and manufacture we can create designs, drawings, animations, user manuals and carry out other consultancy work in addition to prototype and full scale product manufacture.

For more information please see www.bloxwichtrading.com, call +44 (0)1543 435 160 or email technical@bloxwichgroup.com

