

Hinges & Brackets

The choice of hinges, brackets and associated parts depends on end frame and door design and the test requirements for end wall and racking loads. We will be pleased to give detailed advice, but the following points should be considered:

- Forged steel door hinges can usually only be welded to the doors
- Finish, self colour, zinc plated or galvanised are available*
- Nylon (A), (B) & (D) or phosphor bronze (C) bushes are available*
- Bolt-on brackets and hinges can be fitted after final painting
- If repairs are necessary, removal or replacement of bolt-on brackets and hinges is simple
- Flat back design forged steel door hinges are not recommended for use on offshore container main doors
- Customer logos are available subject to minimum order quantities*. No logo (O) is standard
- Grease nipples (N or NSS) can only be fitted to our range of forged hinges (see illustration for fitting positions). Other positions available on request
- Bloxwich recommend Ø12.7 pins or 1/2" bolts are used for Ø12.7 bushes, however if increased clearance is required Ø12 pins or M12 bolts can be fitted*
- For more information and dimensions please visit www.bloxwichdoorgear.com

*Selected hinges only

#Subject to quantity and lead time

Standard Forged Hinge Oil Hole/Grease Nipple Positions

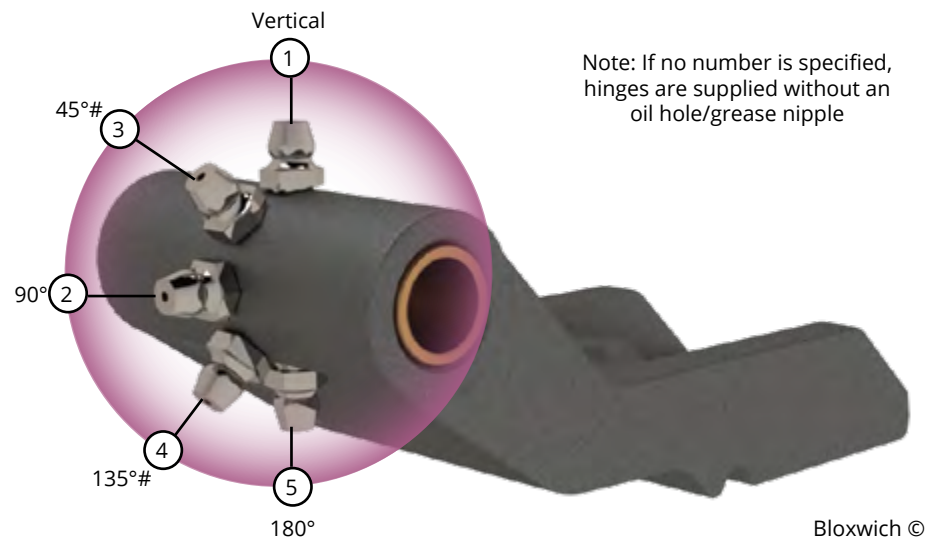

Heavy duty Hinge Oil Hole/Grease Nipple Positions

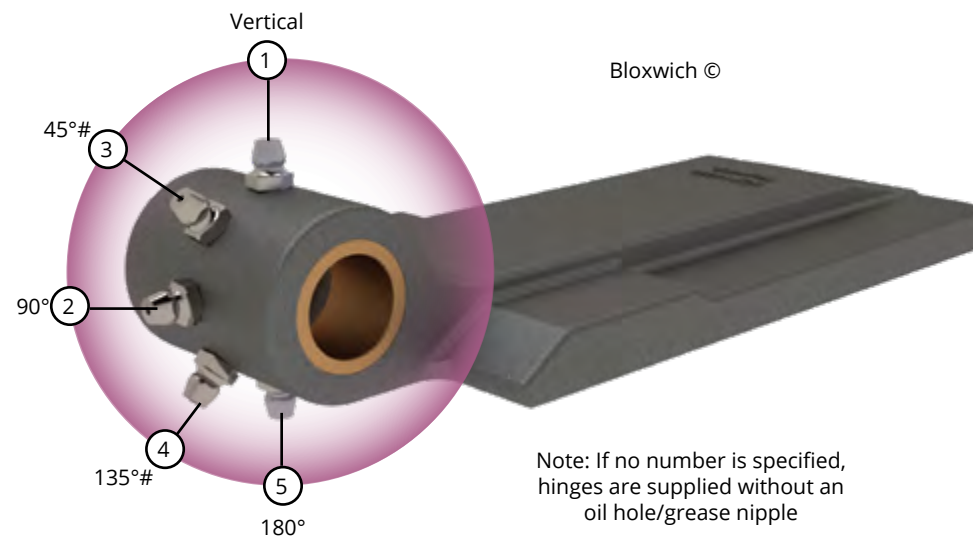

Reverse Hinge Oil Hole/Grease Nipple Positions

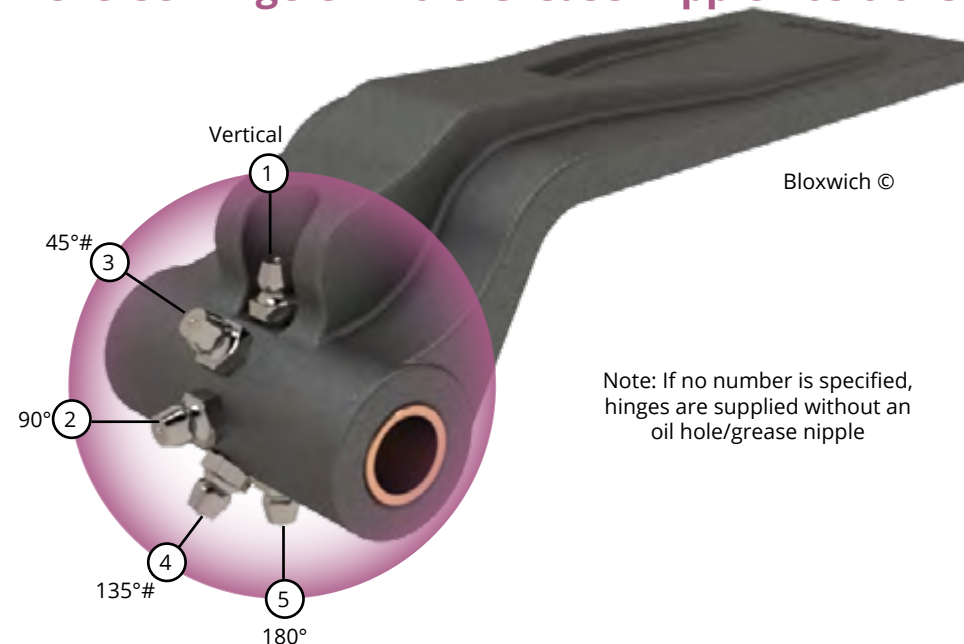

Bush Options

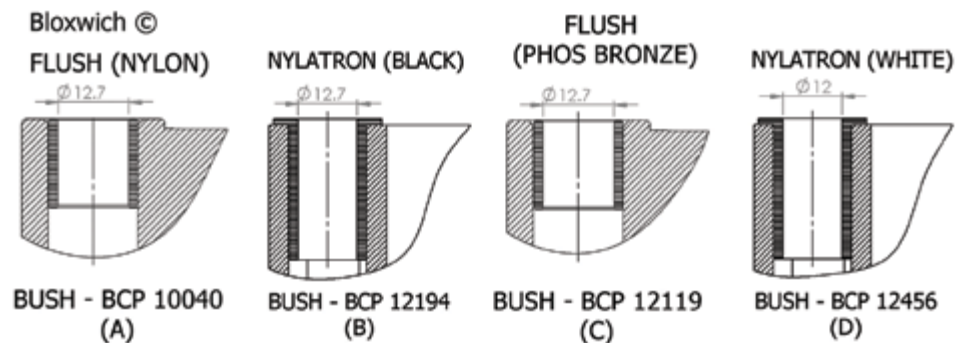

Seal-Groove Hinges

- Gives greater hinge life
- Sealant forms barrier across unwelded part of hinge (dependent upon the design)
- Prevents corrosion by stopping ingress of water behind hinge
- Sealant easily applied by conventional sealant gun
- Prevents rust streaks (as found with conventional hinges) from forming on doors
- Seal-groove provides visual proof that the hinge has been sealed over total width

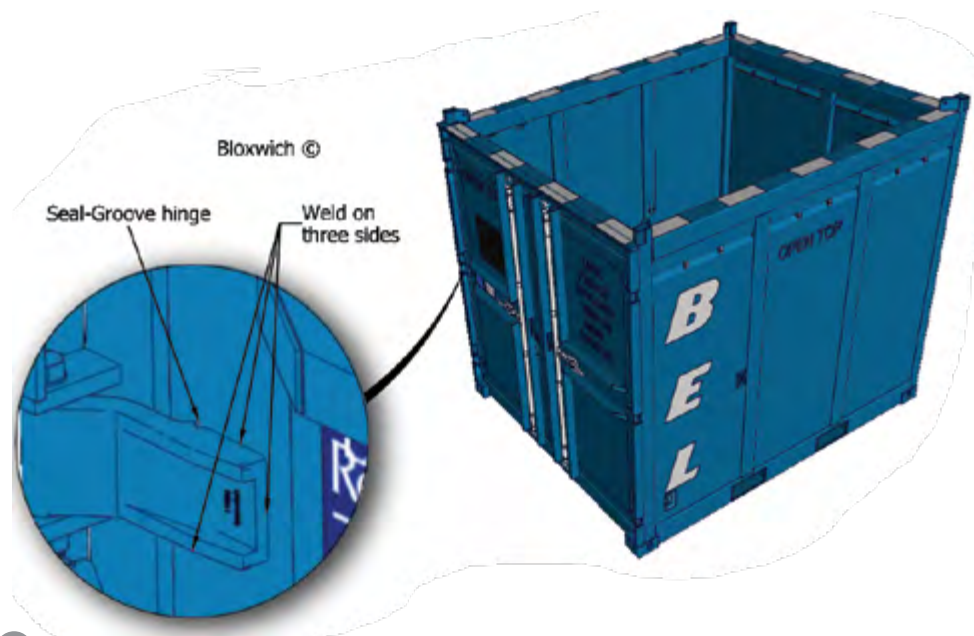

Bloxwich Hinge Pin & Bolt Arrangements

Below are various hinge pin & bolt arrangements. Numerous other configurations are available, we will be pleased to give detailed advice, but the following points should be considered:

- The below are only recommendations and the racking and door burst capabilities of the vehicle or unit must be established by the designer.
- Bloxwich recommend the fitment of grease nipples and regular inspection and maintenance of hinge components in service.
- Made by Bloxwich in accordance with our design standards, copyrights, trademarks and patents.
- When required Bloxwich provide certificates to 2.2 according to EN10204. When required Bloxwich will provide test results by an independent UK test house as per table of requirements 3-6 of DNV 2.7-1 (2013).

Hinge Pins Crimped & Plain with E Clip Grooves

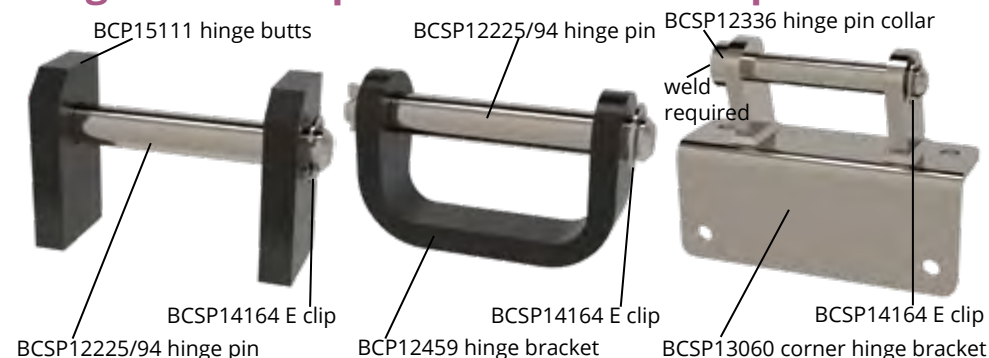

Hinge Pins Plain

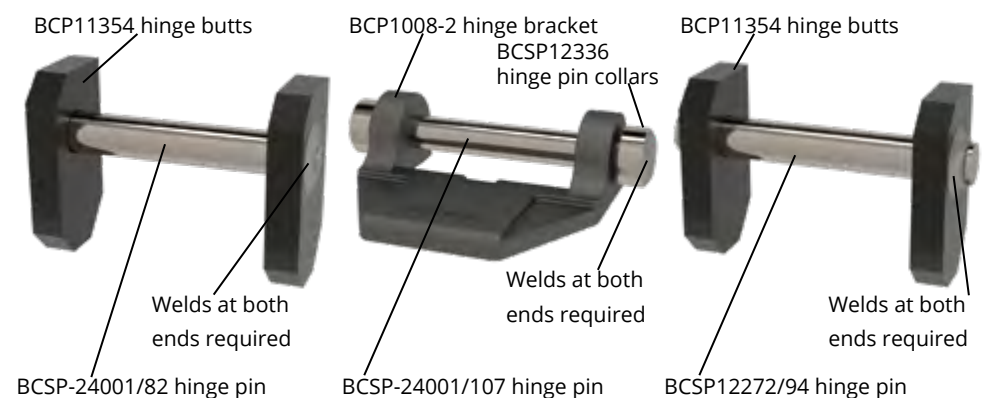

Hinge Bolts

BCP12463 hinge bolt

BCP12462 nyloc nut

BCP14149 hinge bracket

BCSP15120 hinge bolt

BCSP18012 nyloc nut

BCP18007/2 hinge bracket

BCP15125 hinge bolt

BCP12462 nyloc nut

BCP13608 74mm hinge bracket

BCP16054 hinge bolt

BCP16055 nyloc nut

BCP16053 hinge butts

BCSP15121 drilled hinge bolt

BCSP15133 flat washer

BCSP15121 drilled hinge bolt

BCSP15128 castle nut

BCP11354 hinge butts

BCSP15128 castle nut

BCSP15127 cotter pin

BCP11354 hinge butts

Cablelock type customs seal

Model No BCP1032-001 (Mild Steel) Model No BCP1032-002 (Mild Steel) Model No BCP1054-001 (Aluminium) Forged Door Hinge 83/91mm

Supplied in: Self colour

Use: Weld on hinge, to suit Ø12 hinge pin or M12 bolt or Ø12.7 hinge pin or 1/2" bolt or Ø15 hinge pin or 5/8" bolt. See table for details

Can be used with Bloxwich standard or special hinge butts or the BCP1037/010 or BCP1037/003 forged steel gudgeons

Weight: See table



Part No	A	B	C	D	E	Weight	Bush
BCP1032-001	12.7	83	40	76.2	44.5	520 g	N/A
BCP1032-002	16	83	38	76.2	44.5	500 g	N/A
BCP1054-001	12.7	91	42	102	57	270 g	Zinc plated steel bush

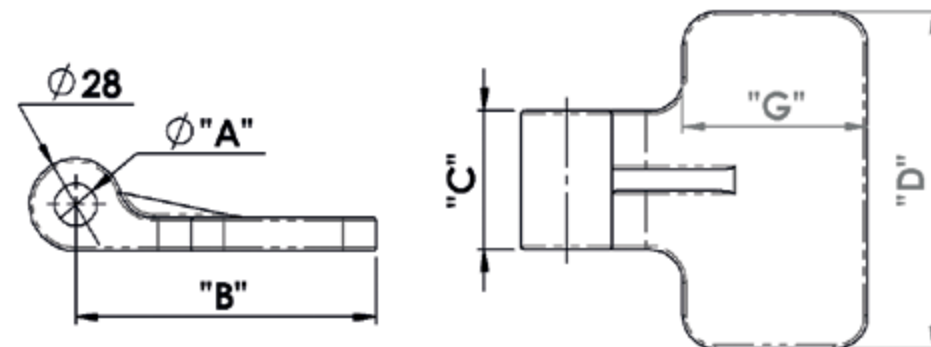

Model No BCP11027 (Mild Steel) Forged Steel Door Hinge 111mm

Supplied in: Self colour or zinc plated

Use: Weld on hinge, bushed to suit Ø12.7 hinge pin or 1/2" bolt. See table for options

Weight: 860 g



Finish	*	Bush No	*	Oil Hole/Grease Nipple Position	*	Nipple	*
Self Colour	S	BCP 10040	A	None	1	None	
				Vertical			
				Horizontal			
Zinc	Z	BCP 12119	C	45°	3	BCP 12595 Mild Steel	N
				135°			
				180°			
						BCSP 12595 Stainless Steel	NSS

*When ordering, please add the above 'characters' to the part number to indicate required condition, e.g. BCP11027SA1N indicates self colour with BCP10040 bush, vertical oil hole and BCP12595 mild steel grease nipple.

Please refer to the oil hole/grease nipple positions and bush options illustrations at the beginning of the section for more information.

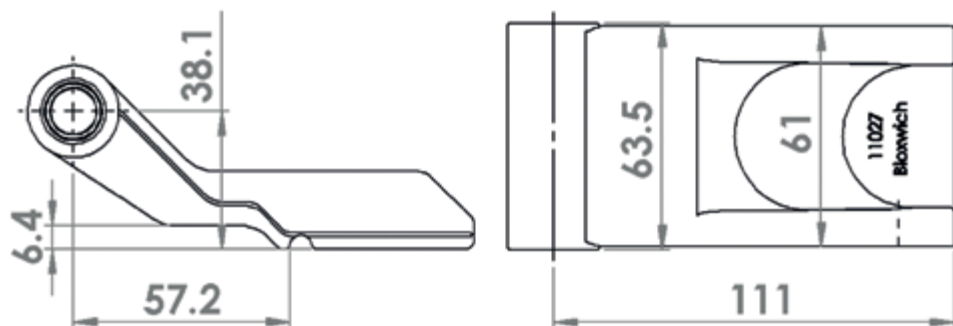

Model No BCP13993 (Mild Steel) Forged Steel Door Hinge 115mm

Supplied in: Self colour or zinc plated

Use: Weld on hinge, un-bushed Ø16.5 or bushed to suit Ø12.7 hinge pin or 1/2" bolt. See table for options

Weight: 475 g



Finish	*	Bush No	*	Oil Hole/Grease Nipple Position	*	Nipple	*
Self Colour	S	Un-bushed		None	1	None	
				Vertical			
				Horizontal			
Zinc	Z	BCP 12119M	C	45°	3	BCP 12595 Mild Steel	N
				135°			
				180°			
						BCSP 12595 Stainless Steel	NSS

*When ordering, please add the above 'characters' to the part number to indicate required condition, e.g. BCP13993SC1N indicates self colour with BCP12119M bush, vertical oil hole and BCP12595 mild steel grease nipple.

Please refer to the oil hole/grease nipple positions and bush options illustrations at the beginning of the section for more information.

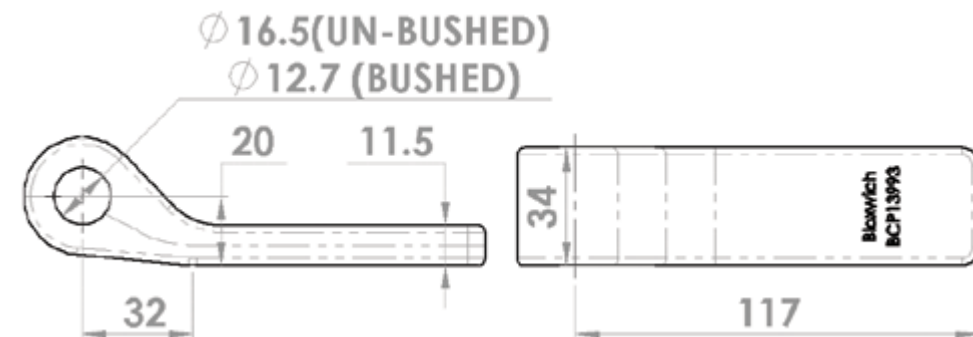

Model No BCP11026 (Mild Steel) Model No BCSP11026#(Stainless Steel) Forged Steel Door Hinge 130mm

Supplied in: Self colour or zinc plated

Use: Weld on hinge, bushed to suit Ø12.7 hinge pin or 1/2" bolt. See table for options

Weight: 940 g

#Subject to quantity and lead time



Finish	*	Bush No	*	Oil Hole/Grease Nipple Position	*	Nipple	*
Self Colour	S	BCP 10040	A	None	1	None	
				Vertical			
				Horizontal			
Zinc	Z	BCP 12119	C	45°	3	BCP 12595 Mild Steel	N
				135°			
				180°			
					4	BCSP 12595 Stainless Steel	NSS
					5		

*When ordering, please add the above 'characters' to the part number to indicate required condition, e.g. BCP11026SA1N indicates self colour with BCP10040 bush, vertical oil hole and BCP12595 mild steel grease nipple.

Please refer to the oil hole/grease nipple positions and bush options illustrations at the beginning of the section for more information.

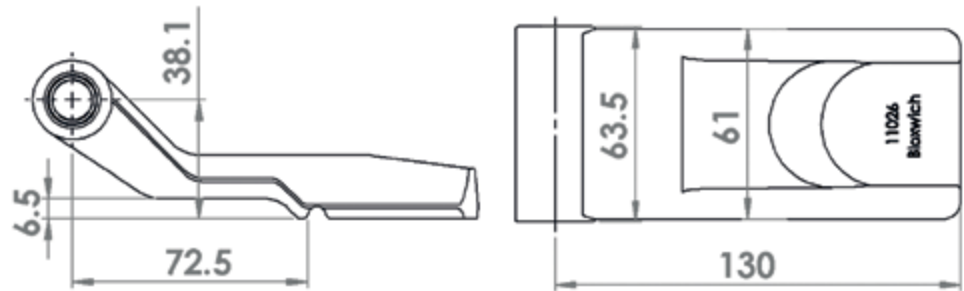

Model No BCP11026DM (Mild Steel) Forged Steel Door Hinge 130mm

Supplied in: Self colour or zinc plated

Use: Weld on flat back design, bushed to suit Ø12.7 hinge pin or 1/2" bolt.

Not recommended for use on offshore container main doors. See table for options

Weight: 940 g



Finish	*	Bush No	*	Oil Hole/Grease Nipple Position	*	Nipple	*
Self Colour	S	BCP 10040	A	None	1	None	
				Vertical			
				Horizontal			
Zinc	Z	BCP 12119	C	45°	3	BCP 12595 Mild Steel	N
				135°			
				180°			
					4	BCSP 12595 Stainless Steel	NSS
					5		

*When ordering, please add the above 'characters' to the part number to indicate required condition, e.g. BCP11026DMA1N indicates self colour with BCP10040 bush, vertical oil hole and BCP12595 mild steel grease nipple.

Please refer to the oil hole/grease nipple positions and bush options illustrations at the beginning of the section for more information.

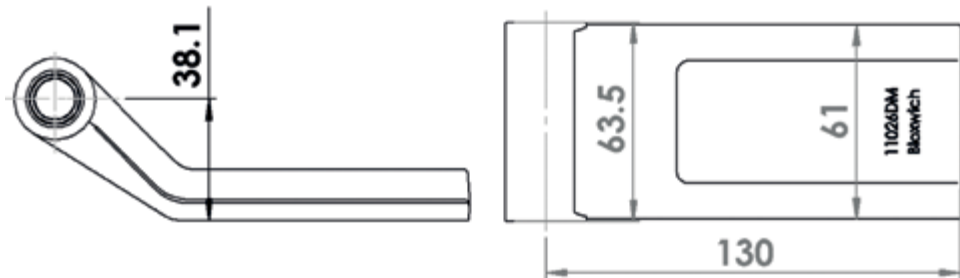

Model No BCP14105 (Mild Steel) Forged Steel Door Hinge 140mm

Supplied in: Self colour or zinc plated

Use: Weld-on stepped back design, bushed to suit Ø12.7mm hinge pin or 1/2" bolt. Suitable for use as replacement or new on shipping container doors as the 80mm width is the same as most current designs of shipping containers made by the large container manufacturers. Stepped back clears door seals.

Weight: 1 kg



Finish	*	Bush No	*	Oil Hole/Grease Nipple Position	*	Nipple	*
Self Colour	S	BCP 10040	A	None	1	None	
				Vertical			
				Horizontal			
Zinc	Z	BCP 12119	C	45°	3	BCP 12595 Mild Steel	N
				135°			
				180°			
Zinc	Z	BCP 12119	C	45°	4	BCSP 12595 Stainless Steel	NSS
				135°			
				180°			

*When ordering, please add the above 'characters' to the part number to indicate required condition, e.g. BCP14105SA1N indicates self colour with BCP10040 bush, vertical oil hole and BCP12595 mild steel grease nipple.

Please refer to the oil hole/grease nipple positions and bush options illustrations at the beginning of the section for more information.

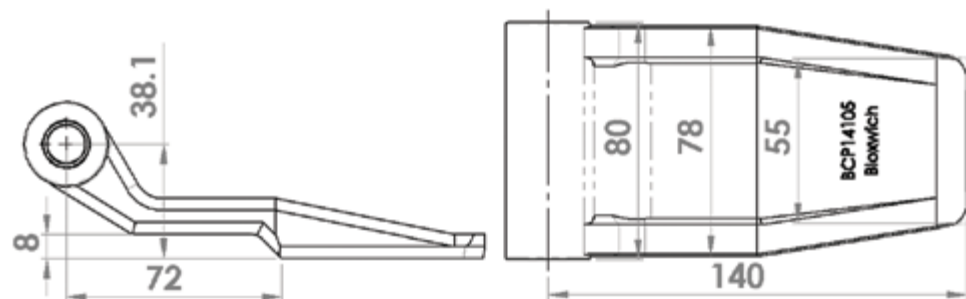

Model No BCP11292 (Mild Steel) Forged Steel Door Hinge 150mm

Supplied in: Self colour or zinc plated

Use: Weld on hinge, bushed to suit Ø12.7 hinge pin or 1/2" bolt. See table for options

Weight: 1.12 kg



Finish	*	Bush No	*	Oil Hole/Grease Nipple Position	*	Nipple	*
Self Colour	S	BCP 10040	A	None	1	None	
				Vertical			
				Horizontal			
Zinc	Z	BCP 12119	C	45°	3	BCP 12595 Mild Steel	N
				135°			
				180°			
Zinc	Z	BCP 12119	C	45°	4	BCSP 12595 Stainless Steel	NSS
				135°			
				180°			

*When ordering, please add the above 'characters' to the part number to indicate required condition, e.g. BCP11292SA1N indicates self colour with BCP10040 bush, vertical oil hole and BCP12595 mild steel grease nipple.

Please refer to the oil hole/grease nipple positions and bush options illustrations at the beginning of the section for more information.

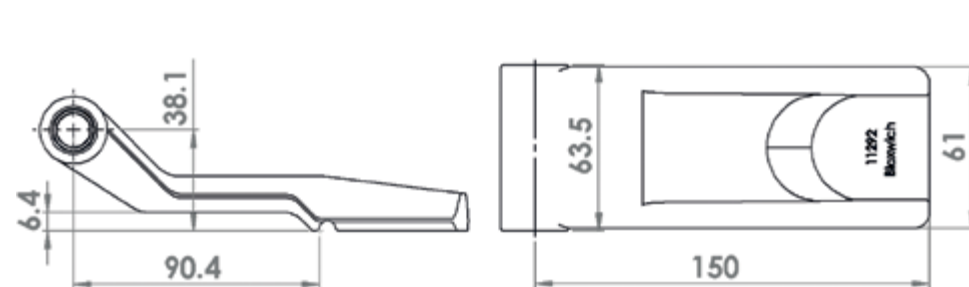

Model No BCP18020 (Mild Steel) Fabricated Steel Door Hinge 155mm

Supplied in: Self colour or zinc plated

Use: Weld on hinge to suit Ø12.7 hinge pin or 1/2" bolt. Can also be used with the BCP1037 weld-on gudgeons.

Weight: 340 g

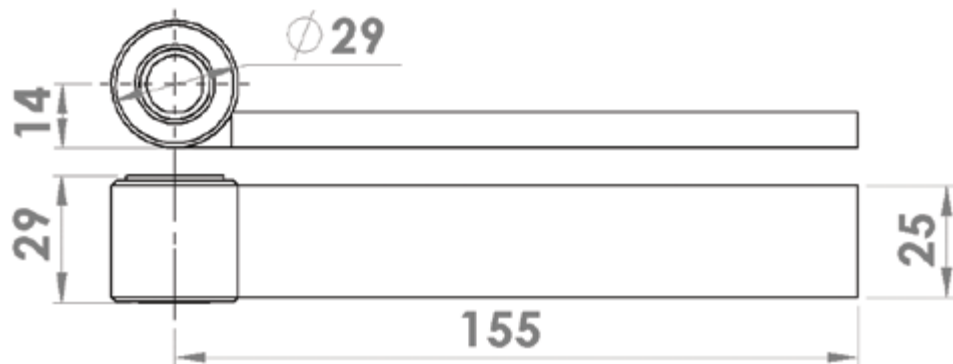
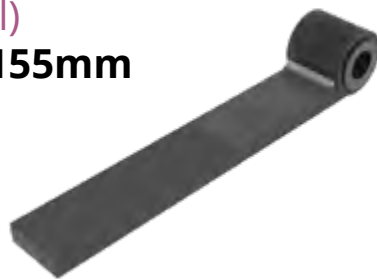

Plastic Injection Moulding Capacity



At Bloxwich Stamping we produce a variety of plastic injection mouldings in a range of colours for lots of different customers but we're always looking for more. Please contact us for more details



+44 (0)1543 435 160

sales@bloxwichgroup.com

bloxwichstamping.com



bloxwich
STAMPING

Model No BCP16052 (Mild Steel) HD Forged Steel Door Hinge 197mm

Supplied in: Self colour or zinc plated

Use: Weld-on design heavy duty hinge, bushed to suit Ø20mm hinge pin or 3/4" UNC bolt. Depending on mounting arrangement and opening angle some positions may not be suitable for a grease nipple.

Weight: 2.3 kg



Finish	*	Oil Hole/Grease Nipple Position	*	Nipple	*
Self Colour	S	None		None	
		Vertical	1		
		Horizontal	2		
Zinc	Z	45°	3	BCP 12595 Mild Steel	N
		135°	4	BCSP 12595 Stainless Steel	NSS
		180°	5		

*When ordering, please add the above 'characters' to the part number to indicate required condition, e.g. BCP16052S1N indicates self colour with vertical oil hole and BCP12595 mild steel grease nipple.

Please refer to the oil hole/grease nipple positions and bush options illustrations at the beginning of the section for more information.

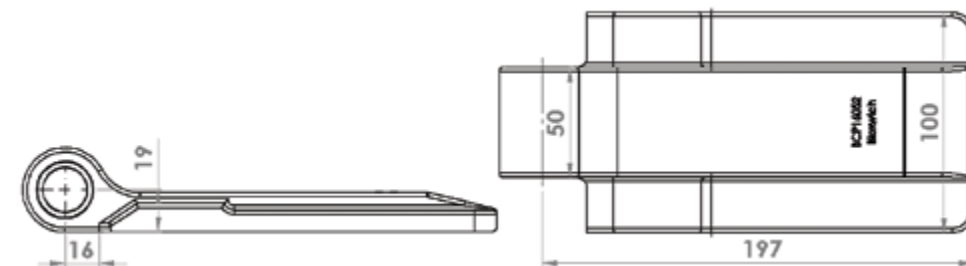

Model No BCP10524 (Mild Steel) Forged Steel Door Hinge 203mm

Supplied in: Self colour or zinc plated

Use: Weld on hinge, bushed to suit Ø12.7 hinge pin or 1/2" bolt. See table for options

Weight: 1.25 kg



Finish	*	Bush No	*	Oil Hole/Grease Nipple Position	*	Nipple	*
Self Colour	S	BCP 10040	A	None	1	None	
				Vertical			
				Horizontal			
Zinc	Z	BCP 12119	C	45°	3	BCP 12595 Mild Steel	N
				135°	4	BCSP 12595 Stainless Steel	
				180°	5	Steel	

*When ordering, please add the above 'characters' to the part number to indicate required condition, e.g. BCP10524SA1N indicates self colour with BCP10040 bush, vertical oil hole and BCP12595 mild steel grease nipple.

Please refer to the oil hole/grease nipple positions and bush options illustrations at the beginning of the section for more information.

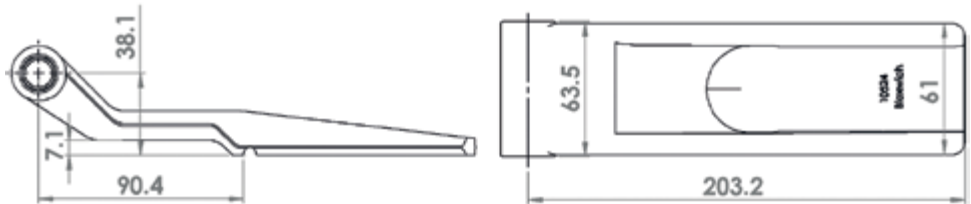

Model No BCP10045 (Mild Steel) Model No BCSP10045# (Stainless Steel) Forged Steel Door Hinge 305mm

Supplied in: Self colour, zinc plated, galvanised or polyester

Use: Weld or bolt on hinge, bushed to suit Ø12.7 hinge pin or 1/2" bolt, Ø10.5 fixing holes. See table for options

Weight: 1.58 kg



#Subject to quantity and lead time

Hole	*	Finish	*	Bush No	*	Oil Hole/Grease Position	*	Nipple	*
10.5	B	Self Colour	S	BCP 10040	A	None		None	
			Vertical			1			
		Zinc	Z	BCP 12119	C	Horizontal	2	BCP 12595 Mild Steel	N
		Galvanised	G			45°	3	BCSP 12595 Stainless Steel	NSS
		Polyester	P			135°	4		
						180°	5		

*When ordering, please add the above 'characters' to the part number to indicate required condition, e.g. BCP10045BZC1N indicates Ø10.5 fixing hole, zinc plated with BCP12119 bush, vertical oil hole and BCP12595 mild steel grease nipple.

Please refer to the oil hole/grease nipple positions and bush options illustrations at the beginning of the section for more information.

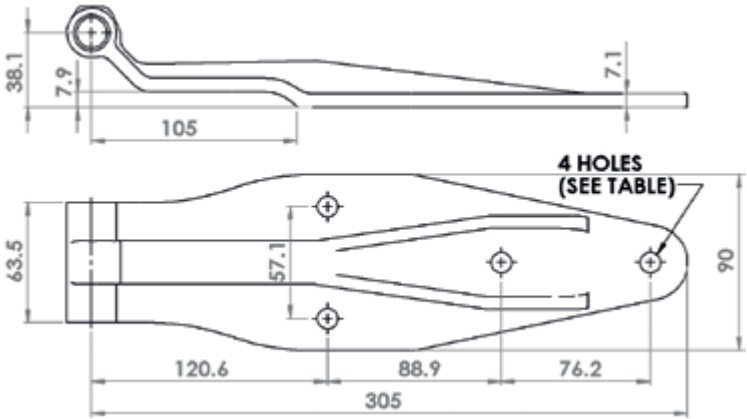

Model No BCP1008-1 (Mild Steel) Forged Steel Reverse Door Hinge 165mm

Supplied in: Self colour or zinc plated

Use: Weld on reverse hinge bushed, to suit Ø12.7 hinge pin or 1/2" bolt. See table for options

For use on sealed or unsealed lids or hatches, reduces the overall height, can be used/ordered with the BCP 1008-2 hinge bracket

Weight: 1.03 kg

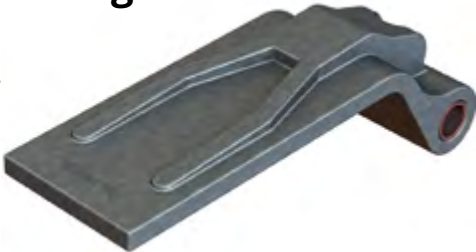

Finish	*	Bush No	*	Oil Hole/Grease Nipple Position	*	Nipple	*
Self Colour	S	BCP 10040	A	None	1	None	
				Vertical			
				Horizontal			
Zinc	Z	BCP 12119	C	45°	3	BCP 12595 Mild Steel	N
				135°	4		
				180°	5	BCSP 12595 Stainless Steel	NSS

*When ordering, please add the above 'characters' to the part number to indicate required condition, e.g. BCP1008-1SA1N indicates self colour with BCP10040 bush, vertical oil hole and BCP12595 mild steel grease nipple.

Please refer to the oil hole/grease nipple positions and bush options illustrations at the beginning of the section for more information.

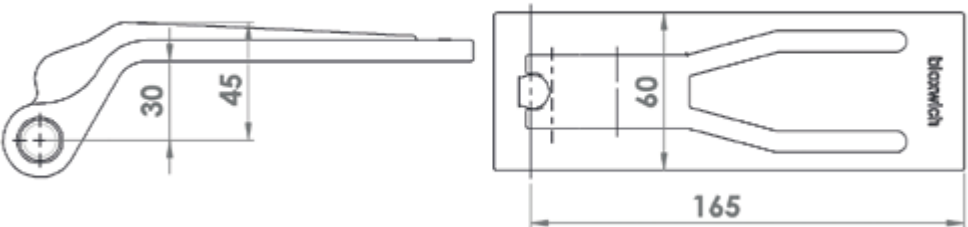

Model No BCP15073 (Mild Steel) Model No BCSP15073 (Stainless Steel) Pressed Hinge 285mm

Supplied in: (Mild Steel only) self colour, zinc plated, galvanised or polyester and 304 stainless steel

Use: Bolt on hinge, bushed to suit Ø12 hinge pin or M12 bolt or Ø12.7 hinge pin or 1/2" bolt or, Ø10.5 or Ø8.5 fixing holes. See table for options

Weight: 720 g



Hole Ø	*	Logo	*	Finish	*	Bush No	ID	*
10.5	B	No Logo	O	Self Colour	S	BCP 12456	12.0	D
		Customer logos are available subject to minimum order quantities.		Zinc	Z			
				Galvanise	G			
				Polished	V			
8.5	A			Polyester	P	BCP 12194	12.7	B

*When ordering, please add the above 'characters' to the part number to indicate required condition, e.g. BCP15073BOZD indicates mild steel hinge, 10.5 Ø fixing holes, no logo, zinc plated with BCP12456 bush.

For stainless steel version please quote BCSP15073BOVD

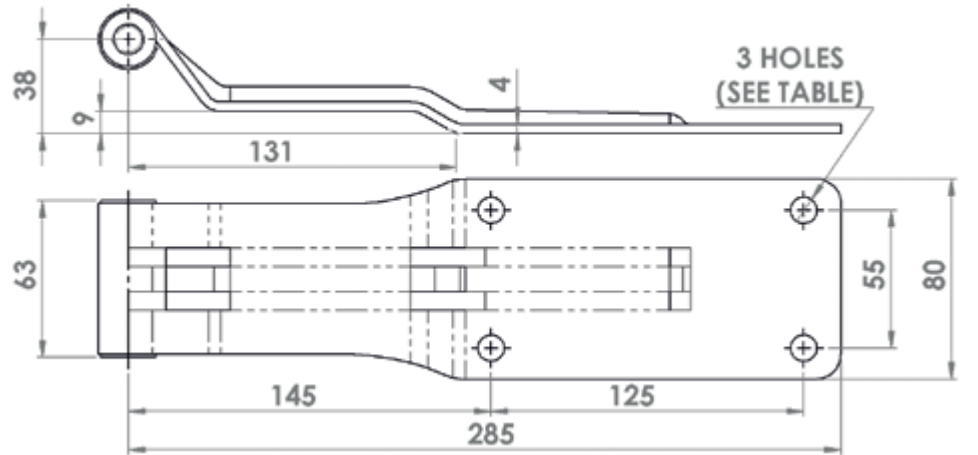

Model No BCP12594 (Mild Steel) Model No BCSP12171 (Stainless Steel) Pressed Hinge 295mm

Supplied in: (Mild Steel only) self colour, zinc plated, galvanised or polyester and 304 stainless steel

Use: Bolt on hinge, bushed to suit Ø12 hinge pin or M12 bolt or Ø12.7 hinge pin or 1/2" bolt or, Ø10.5 or Ø8.5 fixing holes. See table for options

Weight: 620 g



Hole Ø	*	Logo	*	Finish	*	Bush No	ID	*
10.5	B	No Logo	O	Self Colour	S	BCP 12456	12.0	D
		Customer logos are available subject to minimum order quantities.		Zinc	Z			
				Galvanised	G			
				Polished	V			
8.5	A			Polyester	P	BCP 12194	12.7	B

*When ordering, please add the above 'characters' to the part number to indicate required condition, e.g. BCP12594BOZD indicates mild steel hinge, Ø10.5 fixing holes, no logo, zinc plated with BCP12456 bush.

For stainless steel version please quote BCSP12171BOVD

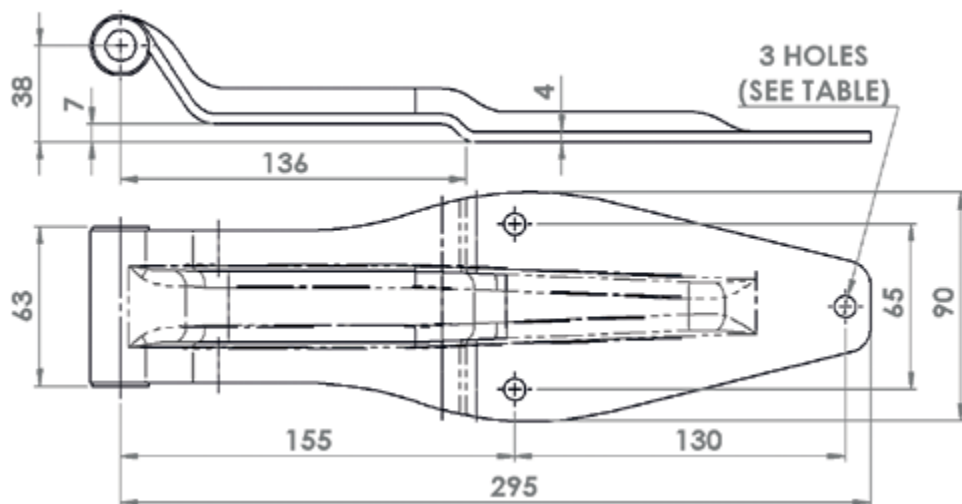

Model No BCP13607 (Mild Steel) Model No BCSP13607 (Stainless Steel) Pressed Hinge 312mm

Supplied in: (Mild Steel only) self colour, zinc plated, galvanised or polyester and 304 stainless steel. See table for options

Use: Bolt on hinge, bushed to suit Ø12 hinge pin or 1/2" bolt or, Ø10.5 or Ø8.5 fixing holes

Weight: 765 g



Hole Ø	*	Logo	*	Finish	*	Bush No	ID	*
10.5	B	No Logo	O	Self Colour	S	BCP 12456	12.0	D
		Customer logos are available subject to minimum order quantities.		Zinc	Z			
				Galvanise	G			
				Polished	V			
8.5	A			Polyester	P	BCP 12194	12.7	B

*When ordering, please add the above 'characters' to the part number to indicate required condition, e.g. BCP13607BOZD indicates mild steel hinge, 10.5 Ø fixing holes, no logo, zinc plated with BCP12456 bush.

For stainless steel version please quote BCSP13607BOVD

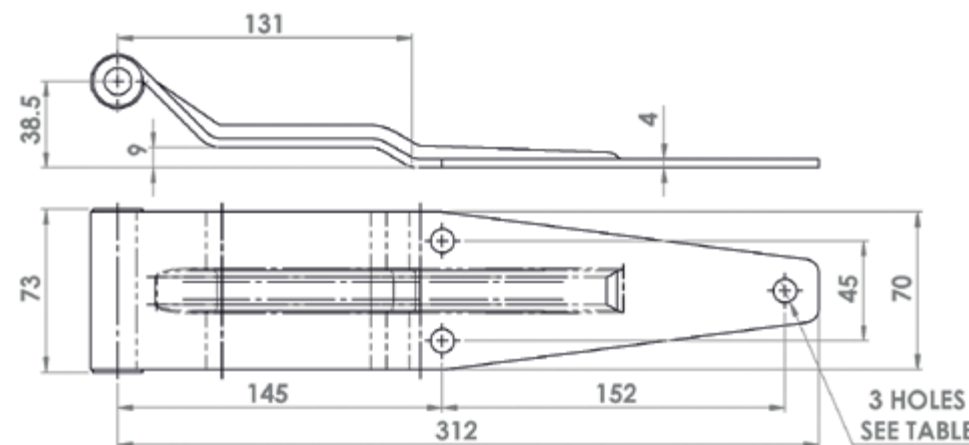

Model No BCP12447 (Mild Steel) Model No BCSP12447 (Stainless Steel) Pressed Hinge 356mm

Supplied in: (Mild Steel only) self colour, zinc plated, galvanised or polyester and 304 stainless steel

Use: Bushed to suit Ø12 hinge pin or M12 bolt or Ø12.7 hinge pin or 1/2" bolt, Ø10.5 or Ø8.5 fixing holes. See table for options

Weight: 1.2 kg



Hole Ø	*	Logo	*	Finish	*	Bush No	ID	*
10.5	B4	No Logo	O	Self Colour	S	BCP 12456	12.0	D
	B6	Customer logos are available subject to minimum order quantities.		Zinc	Z			
8.5	A6			Galvanised	G			
				Polished	V			
				Polyester	P	BCP 12194	12.7	B

*When ordering, please add the above 'characters' to the part number to indicate required condition, e.g. BCP12447B4OZD indicates mild steel hinge, with four 10.5 Ø fixing holes, no logo, zinc plated with BCP12456 bush.

For stainless steel version please quote BCSP12447BOVD

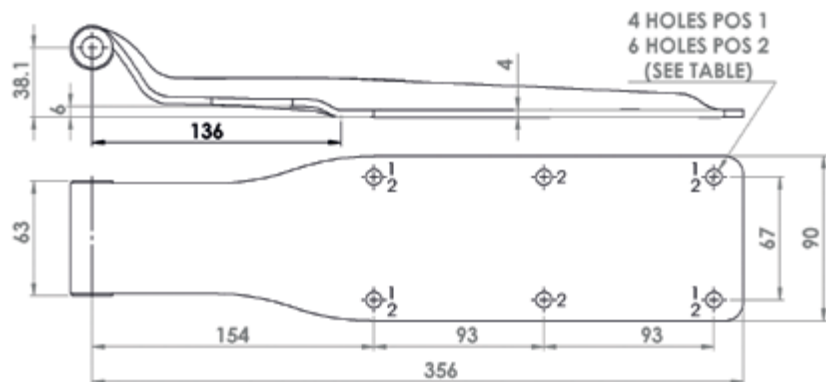

Model No BCP (Mild Steel) Forged Hinge Welded Assemblies

Supplied in: Self colour or zinc plated hinges with self colour hinge butts and stainless steel pin

Use: For containers etc, parts supplied assembled ready to weld in place. Weld-on design, bushed to suit Ø12.7mm hinge pin or 1/2" bolt.

Hinge pin fully welded to the hinge butts

Weight: See table



Model	A	Weight	Finish	*	Bush No	*	Oil Hole/ Grease Nip- ple Position	*	Nipple	*
BCP14884	111	1.3 kg	Self Colour	S	BCP 10040	A	None		None	
							Vertical	1		
BCP14467	130	1.3 kg	Zinc	Z	BCP 12119	C	Horizontal	2	BCP12595 Mild Steel	N
							45°	3		
BCP14483	150	1.4 kg					135°	4	BCSP12595 Stainless Steel	NSS
BCP14476	203	1.6 kg					180°	5		

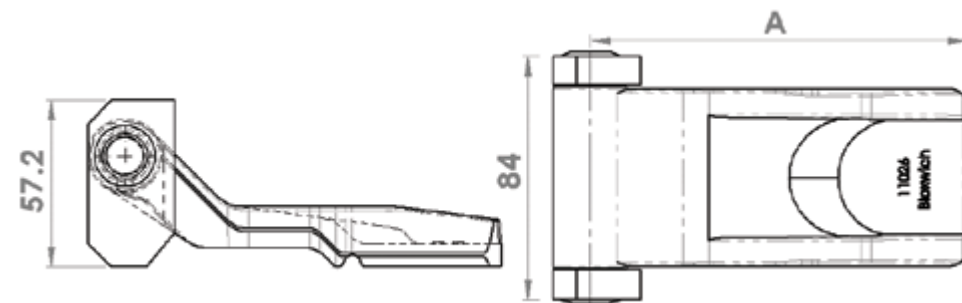

Model No BCP (Mild Steel) Forged Hinge Bolted Assemblies

Supplied in: Self-colour or zinc plated hinge with self-colour hinge butts and stainless steel fasteners. Nyloc nut version available on request please contact us for further details.

Use: For use on containers etc, parts supplied assembled ready to weld in place. Castle nut and split pin provide security but also allow for easy removal of doors for refurb or repair when required.

Customs seal cables can be fitted instead or in addition to the split pin (extra hole required).

Weight: See table



Model	Handing	A	Weight	Finish	*	Bush No	*	Oil Hole /Grease Nipple Position	*	Nipple	*
BCP19005	LH	111	1.3 kg	Self Colour	S	BCP 10040	A	None		None	
BCP15113	LH	130	1.4 kg					Vertical	1		
BCP15114	LH	150	1.5 kg					Horiz	2		
BCP15115	LH	203	1.7 kg					45°	3		
BCP19006	RH	111	1.3 kg	Zinc	Z	BCP 12119	C	135°	4	BCP12595 Mild Steel	N
BCP15117	RH	130	1.4 kg								
BCP15118	RH	150	1.5 kg								
BCP15119	RH	203	1.7 kg					180°	5	BCSP12595 Stainless Steel	

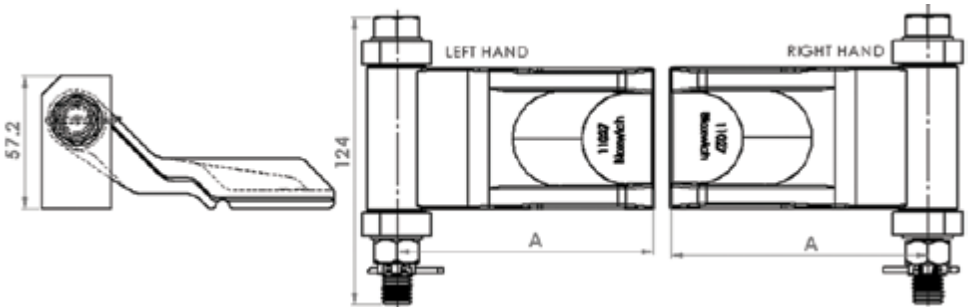

Model No BCP18027 (Left Hand) Model No BCP18028 (Right Hand) Forged Hinge Welded Assemblies

Supplied in: Self colour or zinc plated hinge with self colour hinge bracket and stainless steel pin

Use: Weld-on stepped back design, bushed to suit Ø12.7mm hinge pin or 1/2" bolt. Suitable for use as replacement or new on shipping container doors as the 80mm width is the same as most current designs made by the large container manufacturers. Stepped back clears door seals. Hinge pin fully welded to the hinge brackets at both ends.

Weight: 1.3 kg



Model	Handing	Finish	*	Bush No	*	Oil Hole/ Grease Nipple Position	*	Nipple	*
BCP18027	LH	Self Colour	S	BCP 10040	A	None	1	None	
						Vertical			
						Horizontal			
BCP18028	RH	Zinc	Z	BCP 12119	C	45°	3	BCP12595 Mild Steel	N
						135°			
						180°			

***When ordering,** please add the above 'characters' to the part number to indicate required condition, e.g. BCP18027SA1N indicates left hand, self colour with BCP10040 bush, vertical oil hole and BCP12595 mild steel grease nipple.

Please refer to the oil hole/grease nipple positions and bush options illustrations at the beginning of the section for more information.

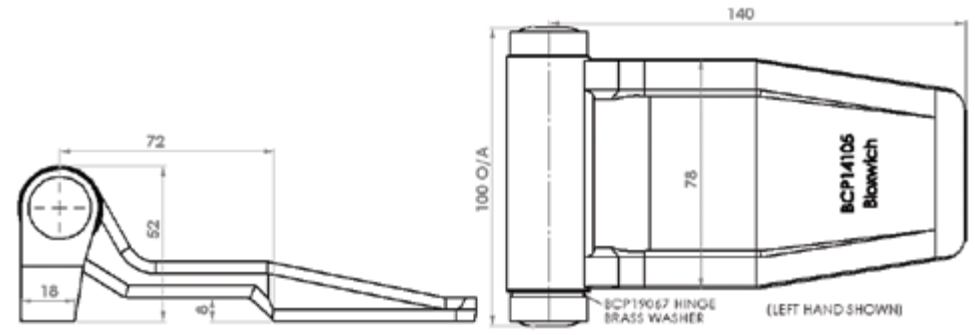

Model No BCP18036 Forged Universal Hinge Welded Assembly

Supplied in: Self colour or zinc plated hinge with self colour hinge bracket and stainless steel pin

Use: Weld-on stepped back design, bushed to suit Ø12.7mm hinge pin or 1/2" bolt. Suitable for use as replacement or new on shipping container doors as the 80mm width is the same as most current designs made by the large container manufacturers. Stepped back clears door seals. Hinge pin fully welded to the hinge brackets at both ends.

Weight: 1.6 kg



Model	Handing	Finish	*	Bush No	*	Oil Hole/ Grease Nip- ple Position	*	Nipple	*
BCP18036	LH or RH	Self Colour	S	BCP 10040	A	None	1	None	N
						Vertical			
						Horizontal			
		Zinc	Z	BCP 12119	C	45°	3	BCSP12595 Mild Steel	
						135°			
						180°			
						5	BCSP12595 Stainless Steel	NSS	

*When ordering, please add the above 'characters' to the part number to indicate required condition, e.g. BCP18036SA1N indicates left hand, self colour with BCP10040 bush, vertical oil hole and BCP12595 mild steel grease nipple.

Please refer to the oil hole/grease nipple positions and bush options illustrations at the beginning of the section for more information.

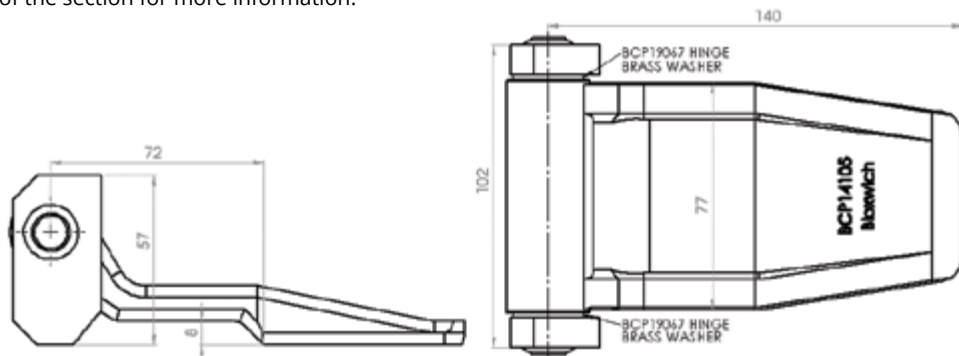

Model No BCP18029 (Left Hand) Model No BCP18030 (Right Hand) Forged Hinge Welded Assemblies

Supplied in: Self colour or zinc plated hinge with self colour hinge bracket and stainless steel pin

Use: Weld-on design, bushed to suit Ø12.7mm hinge pin. For use on shipping container doors as the 80mm width is the same as most current designs made by the large container manufacturers. Stepped back clears door seals. Hinge pin welded to the hinge pin collars allowing rotation of the pin which increases security as it makes the pins harder to cut through.

Weight: 1.3 kg



Model	Handing	Finish	*	Bush No	*	Oil Hole/ Grease Nip- ple Position	*	Nipple	*
BCP18029	LH	Self Colour	S	BCP 10040	A	None	1	None	N
						Vertical			
						Horizontal			
BCP18030	RH	Zinc	Z	BCP 12119	C	45°	3	BCP12595 Mild Steel	
						135°	4	BCSP12595 Stainless Steel	
						180°	5		

*When ordering, please add the above 'characters' to the part number to indicate required condition, e.g. BCP18029SA1N indicates left hand, self colour with BCP10040 bush, vertical oil hole and BCP12595 mild steel grease nipple.

Please refer to the oil hole/grease nipple positions and bush options illustrations at the beginning of the section for more information.

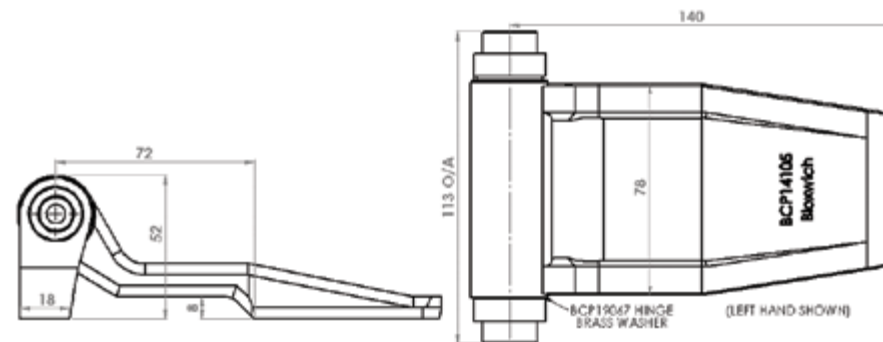

Model No BCP18032 (Left Hand) Model No BCP18033 (Right Hand) Forged Hinge Bolted Assemblies

Supplied in: Self colour or zinc plated hinge with self colour hinge bracket and stainless steel pin

Use: Weld-on stepped back design, bushed to suit Ø12.7mm hinge pin or 1/2" bolt. Suitable for use as replacement or new on shipping container doors as the 80mm width is the same as most current designs made by the large container manufacturers. Stepped back clears door seals.

Weight: 1.3 kg



Model	Handing	Finish	*	Bush No	*	Oil Hole/ Grease Nip- ple Position	*	Nipple	*
BCP18032	LH	Self Colour	S	BCP 10040	A	None	1	None	
						Vertical			
						Horizontal			
BCP18033	RH	Zinc	Z	BCP 12119	C	45°	3	BCP12595 Mild Steel	N
						135°			
						180°			
								BCSP12595 Stainless Steel	NSS

*When ordering, please add the above 'characters' to the part number to indicate required condition, e.g. BCP18032SA1N indicates left hand, self colour with BCP10040 bush, vertical oil hole and BCP12595 mild steel grease nipple.

Please refer to the oil hole/grease nipple positions and bush options illustrations at the beginning of the section for more information.

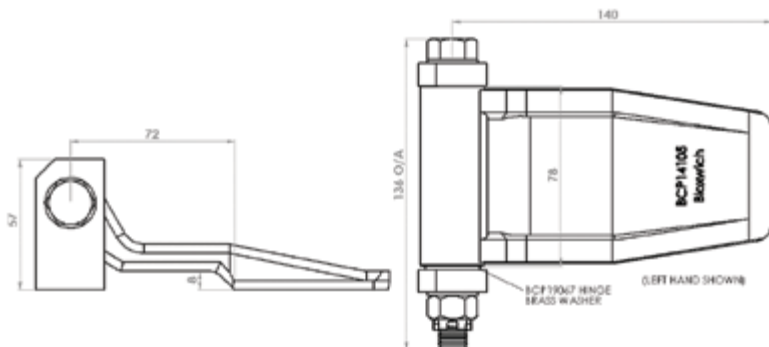

Model No BCP18034 (Left Hand) Model No BCP18035 (Right Hand) Forged Hinge Bolted Assemblies

Supplied in: Self colour or zinc plated hinge with self colour hinge bracket and stainless steel pin

Use: Weld-on stepped back design, bushed to suit Ø12.7mm hinge pin or 1/2" bolt. Suitable for use as replacement or new on shipping container doors as the 80mm width is the same as most current designs made by the large container manufacturers. Stepped back clears door seals.

Weight: 1.3 kg



Model	Handing	Finish	*	Bush No	*	Oil Hole/ Grease Nip- ple Position	*	Nipple	*
BCP18034	LH	Self Colour	S	BCP 10040	A	None	1	None	
						Vertical			
						Horizontal			
BCP18035	RH	Zinc	Z	BCP 12119	C	45°	3	BCP12595 Mild Steel	N
						135°			
						180°			
								BCSP12595 Stainless Steel	NSS

*When ordering, please add the above 'characters' to the part number to indicate required condition, e.g. BCP18032SA1N indicates left hand, self colour with BCP10040 bush, vertical oil hole and BCP12595 mild steel grease nipple.

Please refer to the oil hole/grease nipple positions and bush options illustrations at the beginning of the section for more information.

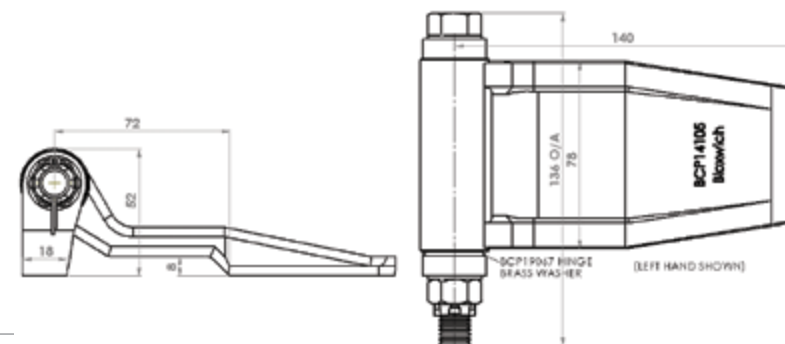

Model No BCP (Mild Steel) HD Welded Hinge Assemblies

Supplied in: Self colour or zinc plated

Use: BCP16052 heavy duty forged steel hinge bushed to suit Ø20mm 304SS pin and fitted with hinge bracket or butts. Pin welded at both ends.

Weight: See table



BCP16051/3



BCP16051/1

BCP16051/5

Model	Finish	*	Oil Hole/ Grease Nip- ple Position	*	Nipple	*	"A"	Weight
BCP16051/1	Self Colour	S	None	1	None		144	3.7 kg
			Vertical					
			Horizontal					
BCP16051/3	Zinc	Z	45°	3	BCP 12595 Mild Steel	N	45	3.0kg
			135°	4	BCSP 12595 Stainless Steel			
			180°	5				
BCP16051/5								

*When ordering, please add the above 'characters' to the part number to indicate required condition, e.g. BCP16051/1S1N indicates self colour with vertical oil hole and BCP12595 mild steel grease nipple.

Please refer to the oil hole/grease nipple positions and bush options illustrations at the beginning of the section for more information.

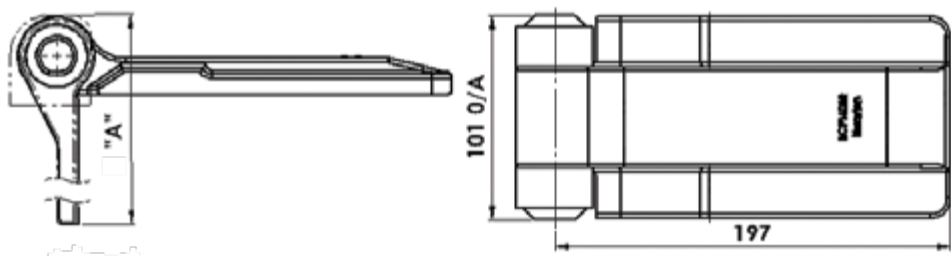

Model No BCP (Mild Steel) HD Bolted Hinge Assemblies

Supplied in: Self colour or zinc plated

Use: BCP16052 heavy duty forged steel hinge bushed to suit 3/4"-10 UNC bolt and fitted with hinge bracket or butts.

Weight: See table



BCP16051/2



BCP16051/4

Model	Finish	*	Oil Hole/ Grease Nip- ple Position	*	Nipple	*	"A"	Weight
BCP16051	Self Colour	S	None	1	None		144	3.7 kg
			Vertical					
			Horizontal					
BCP16051/2	Zinc	Z	45°	3	BCP 12595 Mild Steel	N	45	3.0kg
			135°	4	BCSP 12595 Stainless Steel			
			180°	5				
BCP16051/4								

*When ordering, please add the above 'characters' to the part number to indicate required condition, e.g. BCP16051S1N indicates self colour with vertical oil hole and BCP12595 mild steel grease nipple.

Please refer to the oil hole/grease nipple positions and bush options illustrations at the beginning of the section for more information.

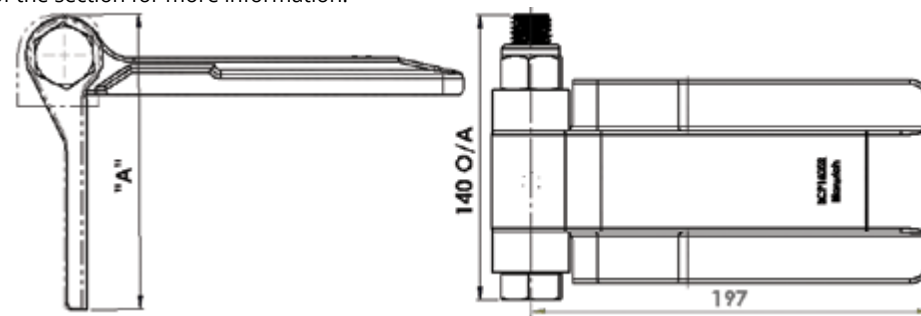

Model No BCP (Mild Steel) Model No BCSP (Stainless Steel) Pressed Hinge Assemblies

Supplied in: (Mild Steel only) self colour, zinc plated, galvanised or polyester and 304 stainless steel

Other combinations available on request please contact us for further details

Use: Parts supplied in unassembled kits to make ordering easier

See the individual parts listed below for dimensions

Weight: See table

Model	Hinge	Bracket	Bolt/Pin	Nut/E Clip	"A"	Weight
BCP14242G	BCP12594BOGD	BCP14149	BCP12463	BCP12462	307	1.1 kg
BCP14242Z	BCP12594BOZD	BCP14149	BCP12463	BCP12462	307	1.1 kg
BCP15105	BCP15073BOZD	BCP14149	BCP12463	BCP12462	297	1.1 kg
BCP15108	BCP13607BOZD	BCP15100	BCP12463	BCP12462	324	1.1 kg
BCP15109	BCP12447A6ZD	BCP14149	BCP12463	BCP12462	368	1.2 kg
BCP15110	BCP12594BOZD	BCP14149	BCP12463	BCP12462	307	1.1 kg
BCSP15105	BCSP15073BOVD	BCSP14149	BCSP12463	BCSP12462	297	1.1 kg
BCSP15108	BCSP13607BOVD	BCSP15100	BCSP12463	BCSP12462	324	1.1 kg
BCSP15109	BCSP12447A6OV2D	BCSP14149	BCSP12463	BCSP12462	368	1.2 kg
BCSP15110	BCSP12171BOVD	BCSP14149	BCSP12463	BCSP12462	307	1.1 kg

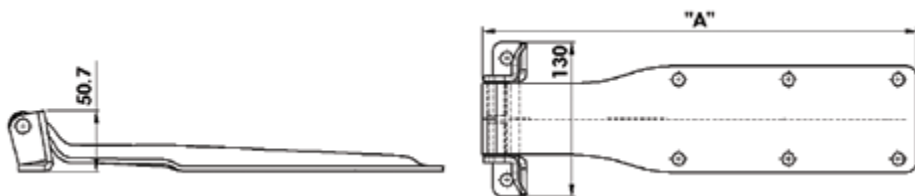

Model No BCP15105 (Mild Steel) Model No BCSP15105 (Stainless Steel) Pressed Hinge Bolted Assemblies

Supplied in: (Mild Steel only) self colour, zinc plated or galvanised and 304 stainless steel

Other combinations available on request please contact us for further details

Use: Parts supplied in unassembled kits to make ordering easier

Weight: 1.1 kg

Model	Finish	Hinge	Bracket	Bolt	Nut
BCP15105	Self colour	BCP15073BOSD	BCP14149	BCP12463	BCP12462
BCP15105/Z	Zinc	BCP15073BOZD	BCP14149/Z	BCP12463	BCP12462
BCP15105/G	Galvanised	BCP15073BOGD	BCP14149/G	BCP12463/G	BCP12462/G
BCSP15105	Polished	BCSP15073BOVD	BCSP14149	BCSP12463	BCSP12462

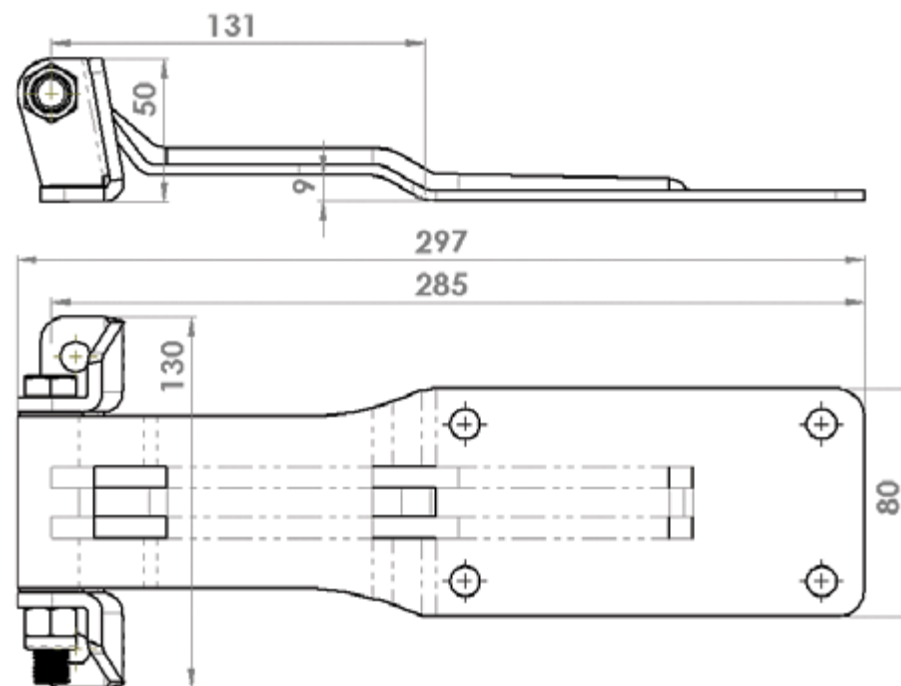

Model No BCP14242 (Mild Steel) Model No BCSP15110 (Stainless Steel) Pressed Hinge Bolted Assemblies

Supplied in: (Mild Steel only) self colour, zinc plated or galvanised and 304 stainless steel

Other combinations available on request please contact us for further details

Use: Parts supplied in unassembled kits to make ordering easier

Weight: 1.1 kg



Model	Finish	Hinge	Bracket	Bolt	Nut
BCP14242	Self colour	BCP12594BOSD	BCP14149	BCP12463	BCP12462
BCP14242/Z	Zinc	BCP12594BOZD	BCP14149/Z	BCP12463	BCP12462
BCP14242/G	Galvanised	BCP12594BOGD	BCP14149/G	BCP12463/G	BCP12462/G
BCSP15110	Polished	BCSP12171BOVD	BCSP14149	BCSP12463	BCSP12462

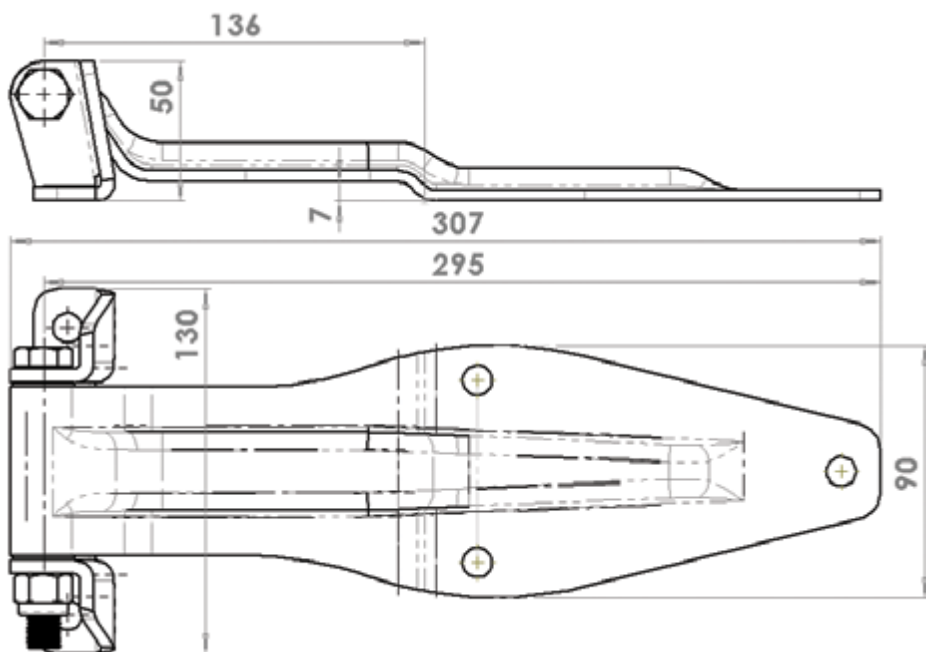

Model No BCP15108 (Mild Steel) Model No BCSP15108 (Stainless Steel) Pressed Hinge Bolted Assemblies

Supplied in: (Mild Steel only) self colour, zinc plated or galvanised and 304 stainless steel

Other combinations available on request please contact us for further details

Use: Parts supplied in unassembled kits to make ordering easier

Weight: 1.1 kg



Model	Finish	Hinge	Bracket	Bolt	Nut
BCP15108	Self colour	BCP13607BOSD	BCP15100	BCP15125	BCP12462
BCP15108/Z	Zinc	BCP13607BOZD	BCP15100/Z	BCP15125	BCP12462
BCP15108/G	Galvanised	BCP13607BOGD	BCP15100/G	BCP15125/G	BCP12462/G
BCSP15108	Polished	BCSP13607BOVD	BCSP15100	BCSP15125	BCSP12462

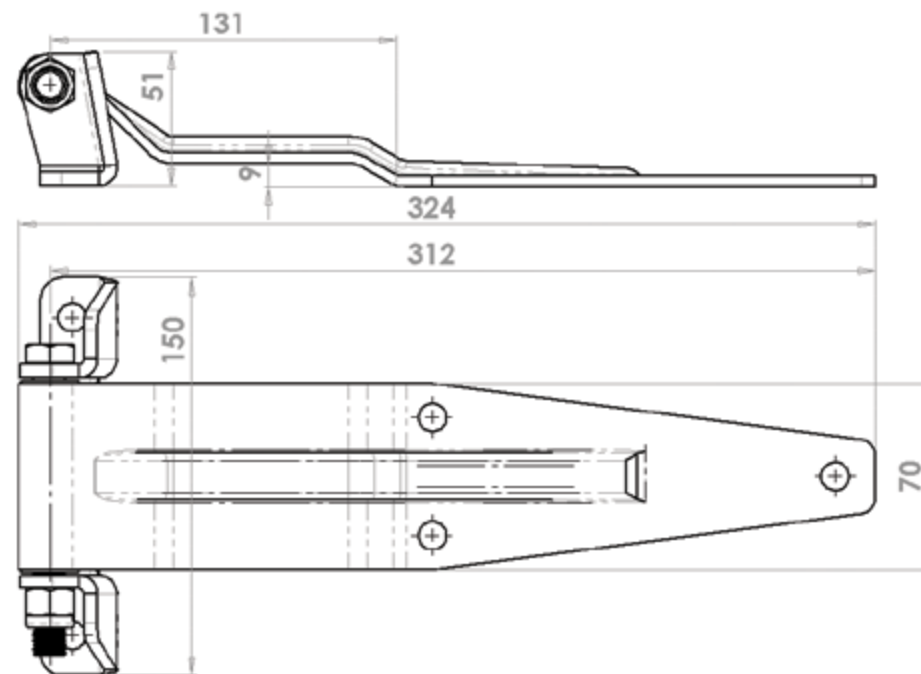

Model No BCP15109 (Mild Steel) Model No BCSP15109 (Stainless Steel) Pressed Hinge Bolted Assemblies

Supplied in: (Mild Steel only) self colour, zinc plated or galvanised and 304 stainless steel

Other combinations available on request please contact us for further details

Use: Parts supplied in unassembled kits to make ordering easier

Weight: 2.2 kg



Model	Finish	Hinge	Bracket	Bolt	Nut
BCP15109	Self colour	BCP12447BOSD	BCP14149	BCP12463	BCP12462
BCP15109/Z	Zinc	BCP12447BOZD	BCP14149/Z	BCP12463	BCP12462
BCP15109/G	Galvanised	BCP12447BOGD	BCP14149/G	BCP12463/G	BCP12462/G
BCSP15109	Polished	BCSP12447BOVD	BCSP14149	BCSP12463	BCSP12462

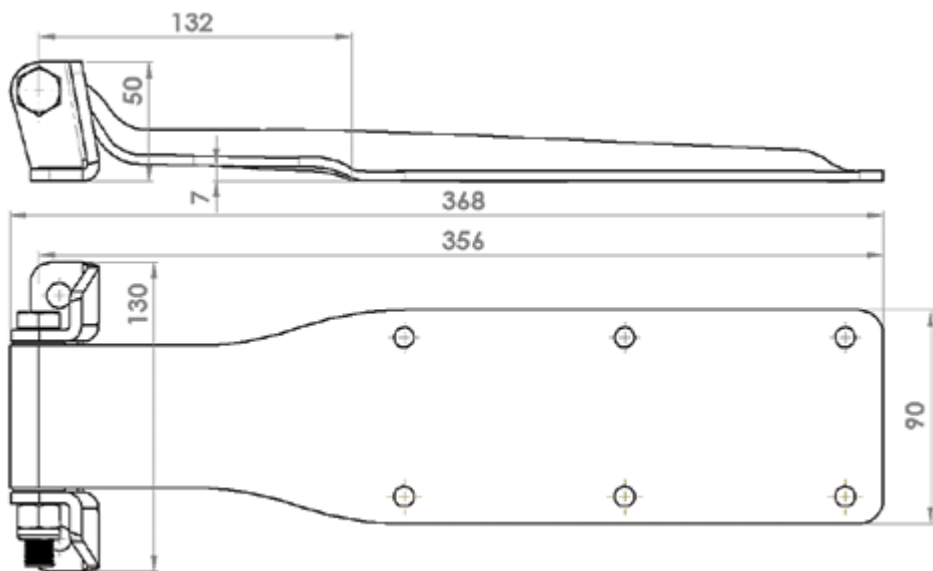

Model No BCP1004 (Mild Steel) Store Hinge Assembly

Supplied in: Self colour

Use: General purpose fabricated hinge assembly for welding into RSA 40 x 40 frame or inside larger RSA's. Fitted with 304 stainless steel pin and Oilite bronze hinge bushes for a smooth and low maintenance operation

Weight: 1.2 kg

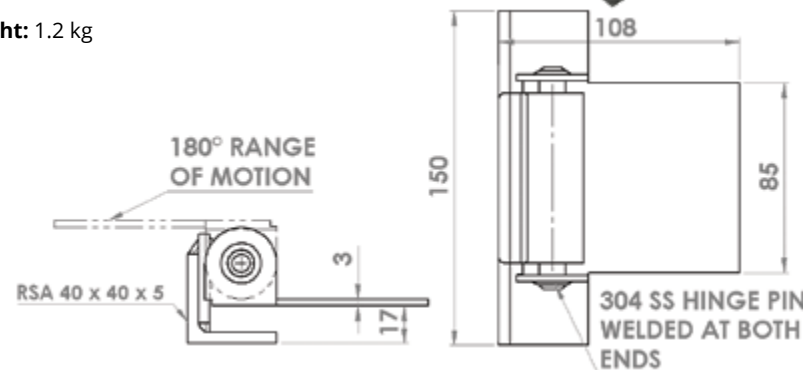

Model No BCP14295 (mild steel) Model No BCSP14295 (stainless steel) Hinge Assembly 107mm

Supplied in: (Mild steel only) zinc plated and 304 stainless steel

Use: Bolt on general purpose hinge assembly with Ø6.4 fixing holes

Weight: 195 g

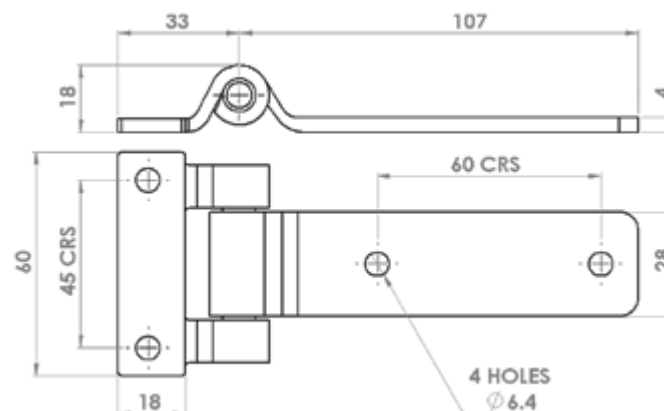
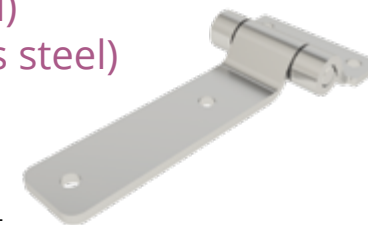

Model No **BCP14296** (mild steel)

Model No **BCSP14296** (stainless steel)

Hinge Assembly 107mm

Supplied in: (Mild steel only) zinc plated and 304 stainless steel

Use: Bolt on general purpose hinge assembly with Ø6.4 fixing holes. Stepped back clears door seals

Weight: 195 g

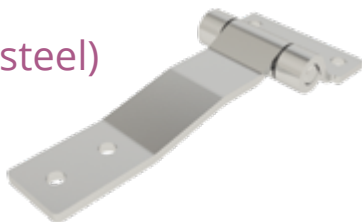
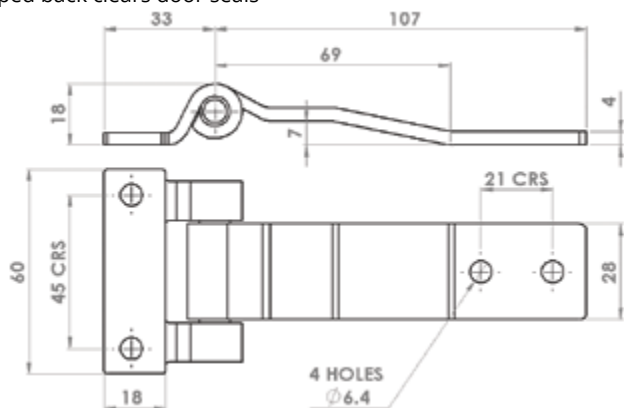

Model No **BCSP13302-***-MB**

Hinge Assembly 95mm

Supplied in: 304 stainless steel electro-polished finish

Use: General purpose pressed stainless steel hinge assembly

Weight: 440 g



Hole	*	Logo	*	Finish	*
Ø8.5mm	A	No Logo	O	Polished	V
Ø10.5mm	B	Customer logos are available subject to minimum order quantities.			
9mm square	C				

*When ordering, please add the above 'characters' to the part number to indicate required condition, e.g. BCSP13302-AOV-MB indicates stainless steel hinge, with Ø8.5mm fixing holes, no logo and a polished finish.

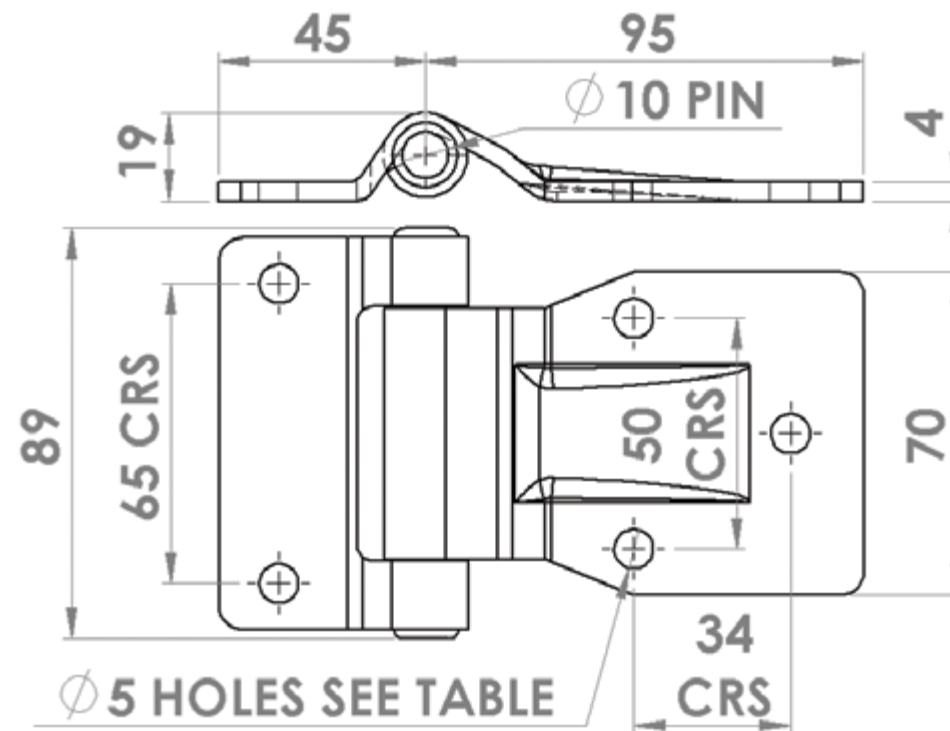

Door Gear - Made in the UK



Our door gear origins go back to the 1960's, today Bloxwich continue to manufacture our large range of Ø22, 27 & 34mm mild steel and stainless steel locking gear in the UK.

For more information please call +44 (0)1543 435 160 or email sales@bloxwichgroup.com



Model No **BCP13302BOZ** (Mild Steel)
 Model No **BCSP13302-**V** (Stainless Steel)
Hinge Assembly 185mm

Supplied in: Mild steel zinc plated or 304 stainless steel electro-polished finish

Use: General purpose pressed mild steel or stainless steel hinge assembly. Swan neck design helps clear door seals

Weight: 650 g



Hole	*	Logo	*	Finish	*
Ø8.5mm	A	No Logo	O	Zinc	Z
Ø10.5mm	B	Customer logos are available subject to minimum order quantities.			
9mm square	C			Polished	V

*When ordering, please add the above 'characters' to the part number to indicate required condition, e.g. BCSP13302-COV indicates stainless steel hinge, with 9mm square fixing holes, no logo and a polished finish.

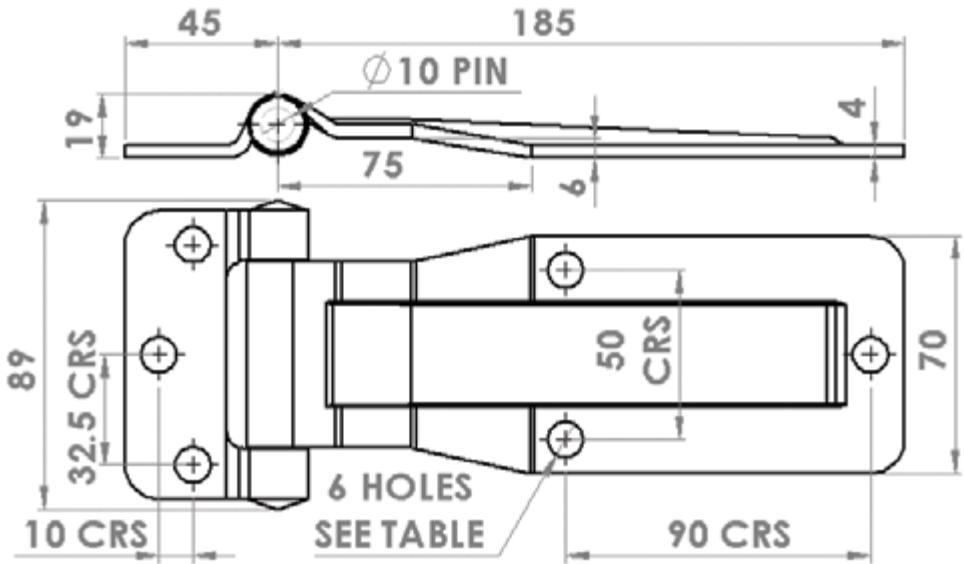

Model No **BCSP13302-**V-MA**
Hinge Assembly 185mm

Supplied in: 304 stainless steel electro-polished finish

Use: General purpose pressed stainless steel hinge assembly. Swan neck design helps clear door seals

Weight: 650 g



Hole	*	Logo	*	Finish	*
Ø8.5mm	A	No Logo	O	Polished	V
Ø10.5mm	B	Customer logos are available subject to minimum order quantities.			
9mm square	C				

*When ordering, please add the above 'characters' to the part number to indicate required condition, e.g. BCSP13302-AOV-MA indicates stainless steel hinge, with Ø8.5mm fixing holes, no logo and a polished finish.

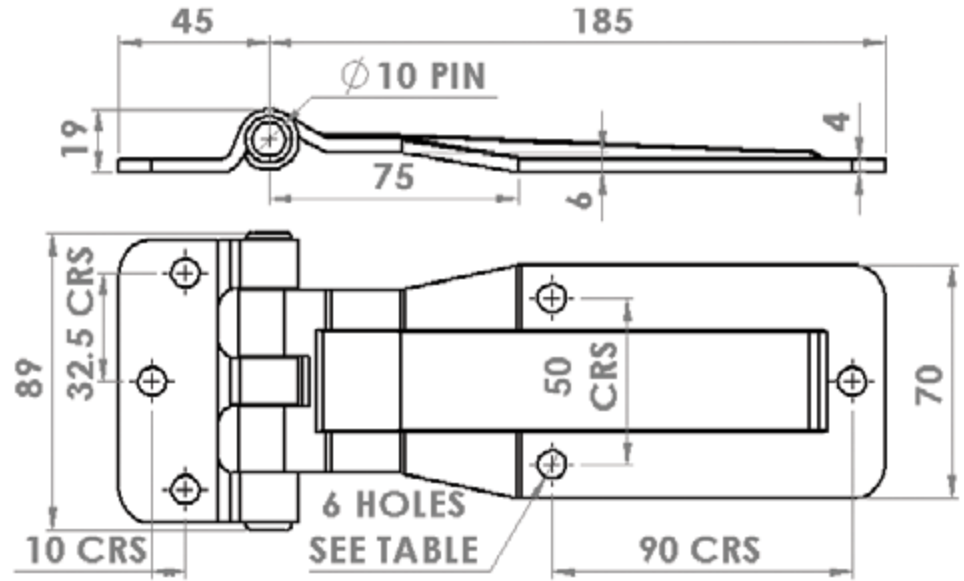

Model No BCSP13302-**-V-M Hinge Assembly 190mm

Supplied in: 304 stainless steel
electro-polished finish

Use: General purpose pressed
stainless steel hinge assembly

Weight: 650 g



Hole	*	Logo	*	Finish	*
Ø8.5mm	A	No Logo	O	Polished	V
Ø10.5mm	B	Customer logos are available subject to minimum order quantities.			
9mm square	C				

*When ordering, please add the above 'characters' to the part number to indicate required condition, e.g. BCSP13302-AOV-M indicates stainless steel hinge, with Ø8.5mm fixing holes, no logo and a polished finish.

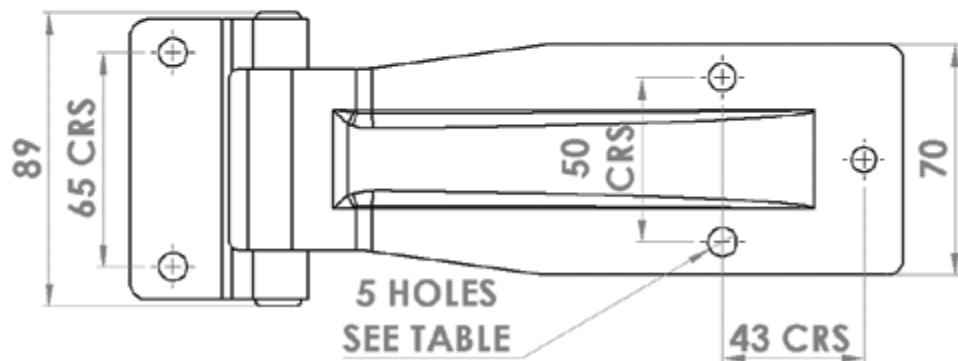
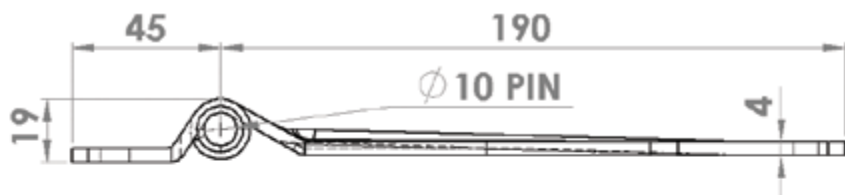

Model No BCP1008 Reverse Hinge Assembly 165mm

Supplied in: Self colour or zinc plated

Use: On sealed or unsealed lids or hatches,
reduces the overall height

Weight: 1.5 kg

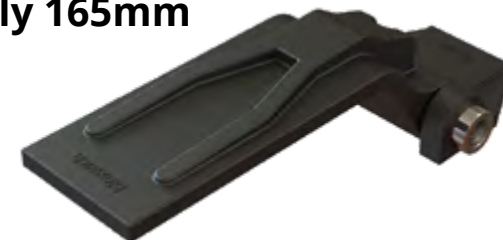

Finish	*	Bush No	*	Oil Hole/Grease Nipple Position	*	Nipple	*
Self Colour	S	BCP 10040	A	None	1	None	
				Vertical			
				Horizontal			
Zinc	Z	BCP 12119	C	45°	3	BCP 12595 Mild Steel	N
				135°			
				180°			
					4	BCSP 12595 Stainless Steel	NSS
					5		

*When ordering, please add the above 'characters' to the part number to indicate required condition, e.g. BCP1008-SA1N indicates self colour with BCP10040 bush, vertical oil hole and BCP12595 mild steel grease nipple.

Please refer to the oil hole/grease nipple positions and bush options illustrations at the beginning of the section for more information.

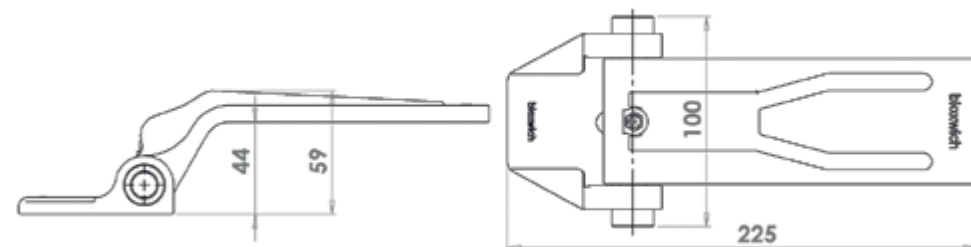

Model No BCP13020Z (Mild Steel) Cranked Door Hinge Assembly

Supplied in: Zinc finish as standard (please contact us if you require a different finish) with plastic and Oilite bronze sintered bushes and a stainless-steel pin

Use: For rear doors where tail lifts are fitted and doors are recessed into end frame

Weight: 3.3 kg

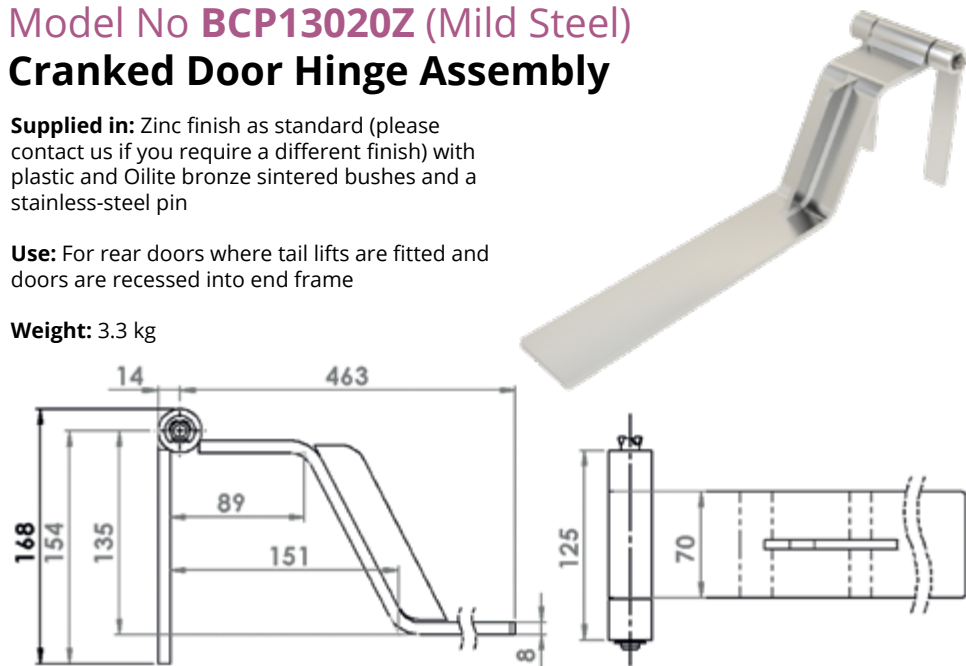

Model No BCP0855/001 (Mild Steel) Coach Hinge Assembly LH 78.5mm

Supplied in: Mild steel self colour with nylon bushes

Use: General purpose weld on hinge assembly left hand. Right hand version BCP0855/002 available on request, please contact us.

Weight: 570 g

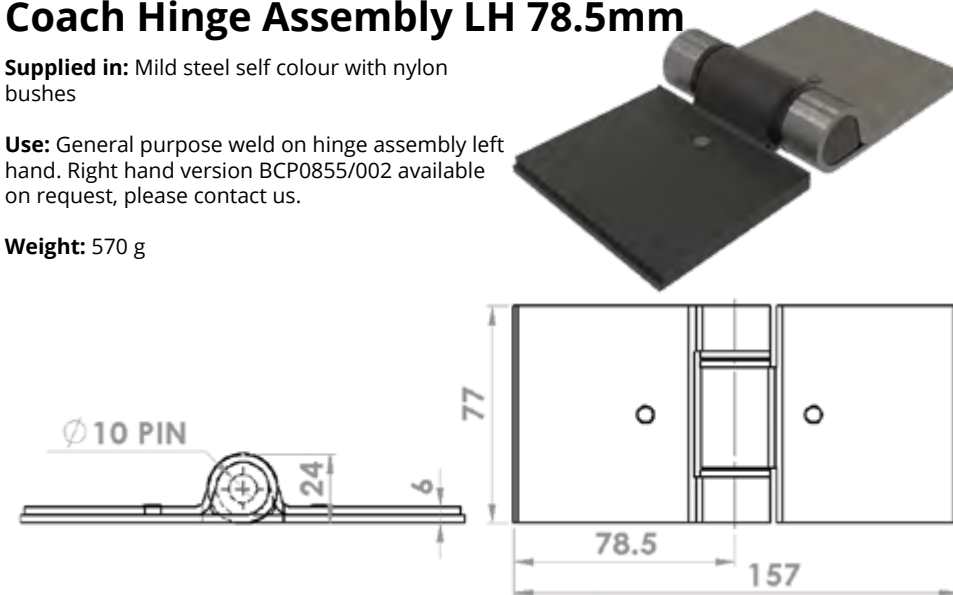

Model No BCP13020/1Z (Mild Steel) Tail Lift Hinge Kit Bolt On

Supplied in: Zinc finish as standard (please contact us if you require a different finish) with plastic and Oilite bronze sintered bushes and a stainless-steel pin

Use: For rear doors where tail lifts are fitted and doors are recessed into end frame

Weight: 3.3 kg

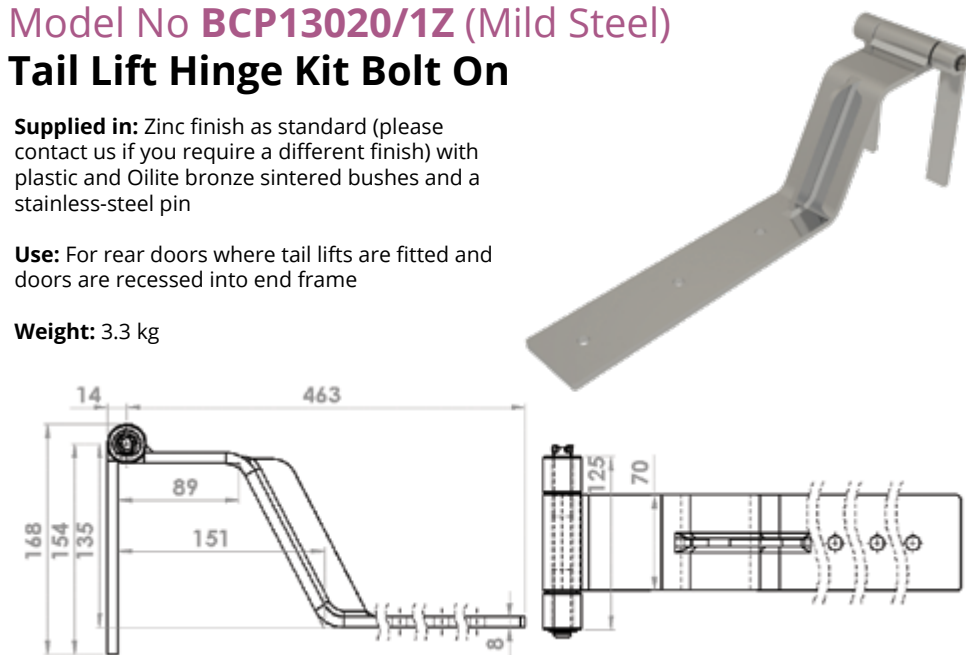

Model No BCP14510Z (Mild Steel) Tailboard Hinge Set

Supplied in: Forged steel hinge parts and mild steel back plate, all with zinc plated finish

Use: Bolt on heavy duty (Ø15mm pin) hinge set for vehicle side and tailboards. Design prevents accidental unhinging. Fasteners not supplied

Weight: 900 g

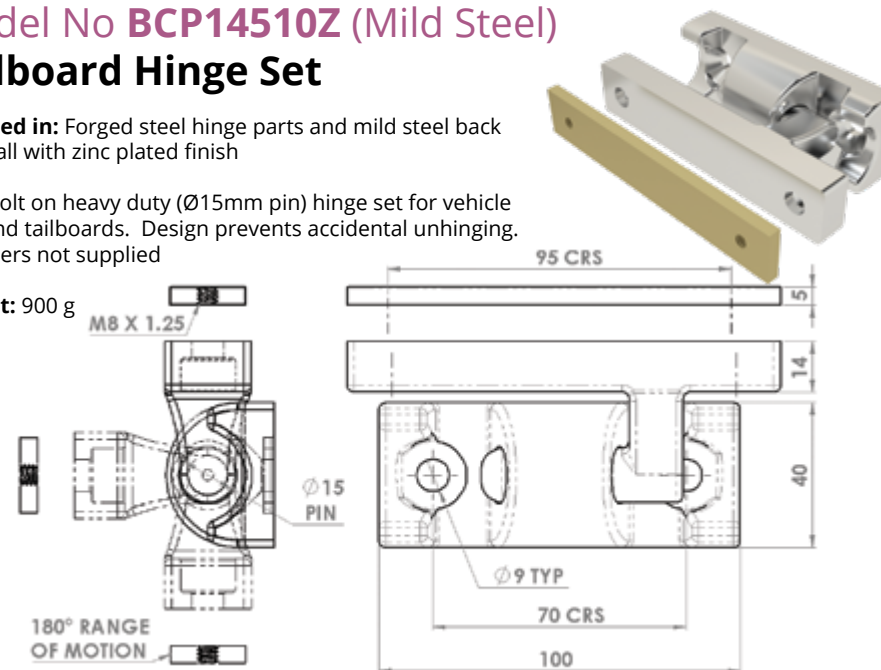

Model No BCP (Mild Steel) Model No BCSP (Stainless Steel) Barrel Hinge Assemblies

Supplied in: Self colour mild steel or 304 stainless steel, with or without grease nipple

Use: Serviceable lift off* barrel hinge. *Depending upon mounting arrangement.

Weight: see table

Other sizes and configurations available on request



Model	Grease Nipple?	Length	Body Ø	Pin Ø	Height	Weight
BCP16015	Yes	100	16	10	20	170 g
BCP16015/1	No	100	16	10	20	170 g
BCSP16015	Yes	100	16	10	20	170 g
BCSP16015/1	No	100	16	10	20	170 g
BCP17026	Yes	150	20	13	25	200 g
BCP17026/1	No	150	20	13	25	200 g
BCSP17026	Yes	150	20	13	25	200 g
BCSP17026/1	No	150	20	13	25	200 g
BCP16014	Yes	180	20	13	25	470 g
BCP16014/1	No	180	20	13	25	470 g
BCSP16014	Yes	180	20	13	25	470 g
BCSP16014/1	No	180	20	13	25	470 g

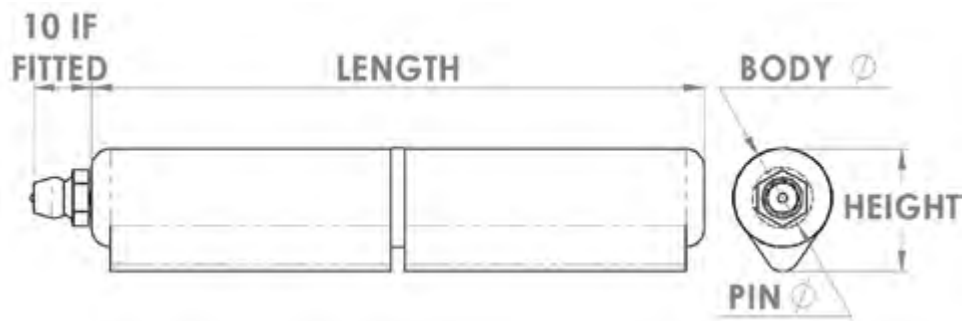

Model No BCP1008-2 (Mild Steel) Hinge Bracket

Supplied in: Self colour, zinc plated or galvanized

Use: Pivot hole size to suit M12 bolt or Ø12 hinge pin or 1/2" version suits 1/2" bolt or Ø12.7 hinge pin. Used with the BCP1008-1 reverse hinge on sealed or unsealed lids or hatches, reduces the overall height

Weight: 300 g

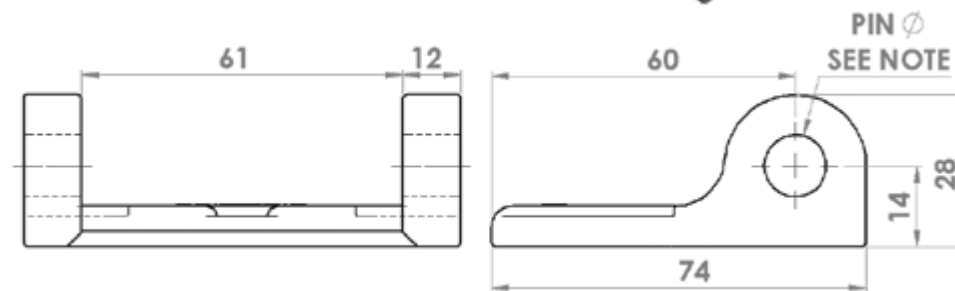
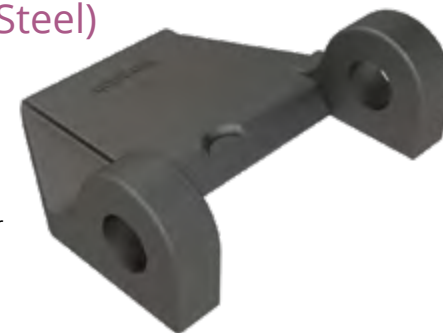

Model No BCP14149 (Mild Steel) Model No BCSP14149 (Stainless Steel) Hinge Bracket 63mm (Offset)

Supplied in: Mild steel self colour, zinc plated or galvanised and 304 stainless steel

Use: Pivot hole size to suit M12 bolt or Ø12 hinge pin or 1/2" version suits 1/2" bolt or Ø12.7 hinge pin. Replaces fabricated BCP12228 hinge bracket

Weight: 290 g

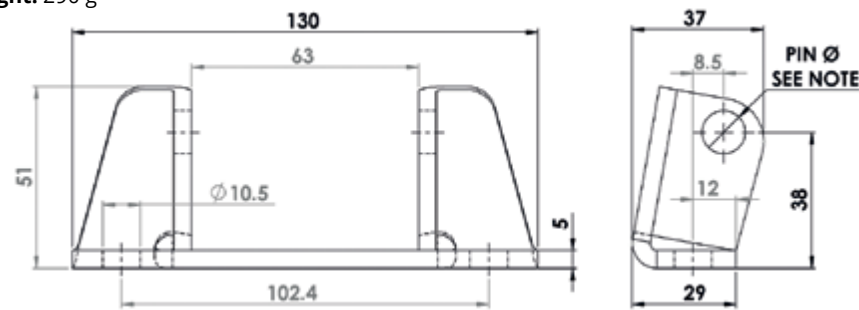

Model No **BCP15100** (Mild Steel)
Model No **BCSP15100** (Stainless Steel)

Hinge Bracket 74mm (Offset)

Supplied in: Mild steel self colour, zinc plated or galvanised and 304 stainless steel

Use: Pivot hole size to suit M12 bolt or Ø12 hinge pin

Weight: 290 g

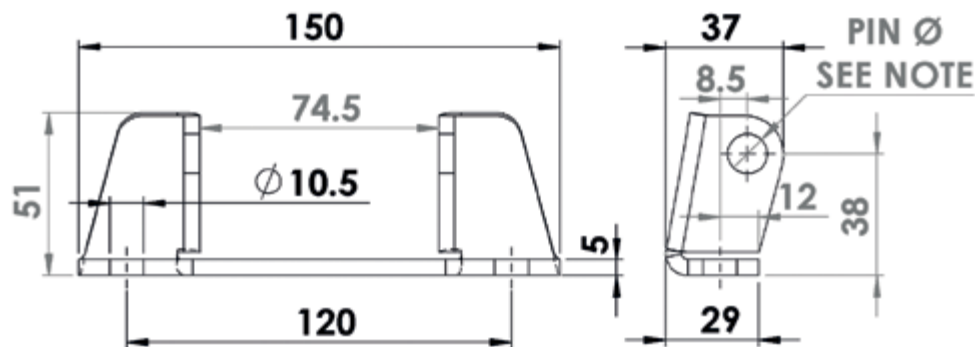

Model No **BCP12459** (Mild Steel)
Hinge Bracket 64mm (Offset)

Supplied in: Self colour, zinc plated or galvanised

Use: /1 pivot hole size to suit M12 bolt or Ø12 hinge pin or /2 version suits 1/2" bolt or Ø12.7 hinge pin.

Weight: 170 g

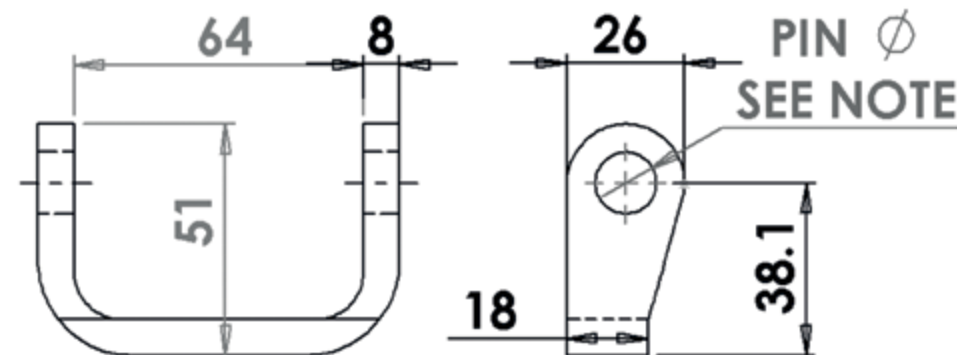

Model No **BCP13608B** (Mild Steel)
Model No **BCSP13608B** (Stainless Steel)

Hinge Bracket 74mm

Supplied in: Mild steel self colour, zinc plated or galvanised and 304 stainless steel

Use: Pivot hole size to suit M12 bolt or Ø12 hinge pin.

Weight: 230 g

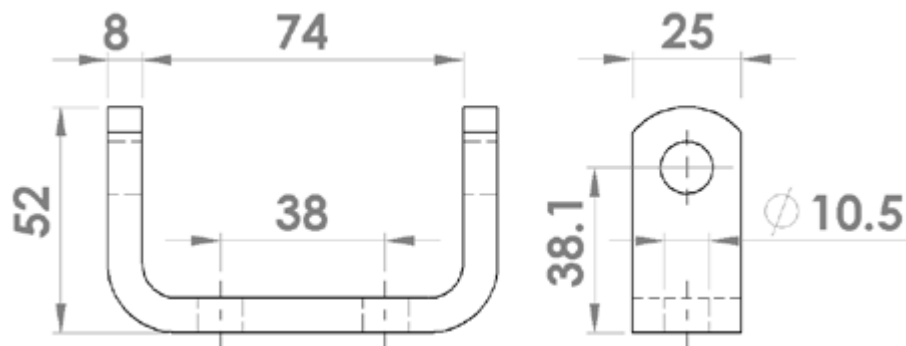
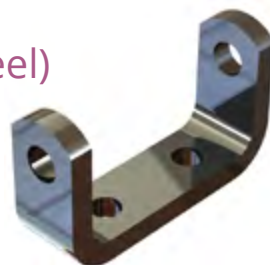

Model No **BCP18007** (Mild Steel)
Hinge Bracket 80mm (Offset)

Supplied in: Mild steel self colour, zinc plated or galvanised

Use: /1 pivot hole size to suit M12 bolt or Ø12 hinge pin or /2 version suits 1/2" bolt or Ø12.7 hinge pin.

Weight: 190 g

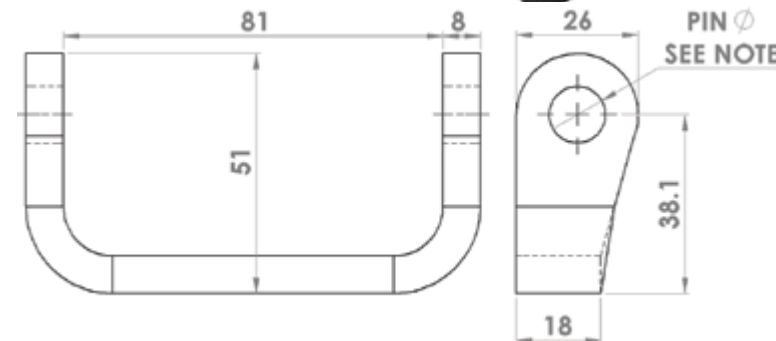

Model No **BCP13060** (Mild Steel)
Model No **BCSP13060** (Stainless Steel)
Corner Hinge Bracket 64mm (Offset)

Supplied in: Mild steel self colour, zinc plated or galvanised and 304 stainless steel

Use: Pivot hole size to suit 1/2" bolt or Ø12.7 hinge pin.

Weight: 500 g

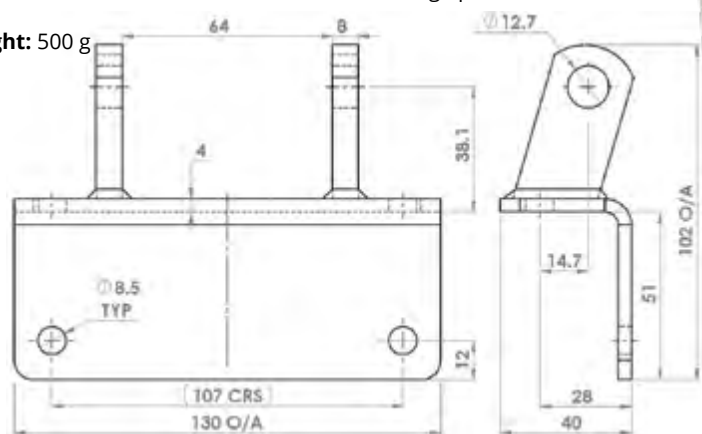

Model No **BCP15111** (Mild Steel)
Model No **BCSP15111#** (Stainless Steel)
Hinge Butt (special)

Supplied in: Mild steel self colour

Use: On all Bloxwich hinges, gives increased clearance for bolting when required. Other sizes available on request. #Subject to quantity and lead time

Weight: 120 g

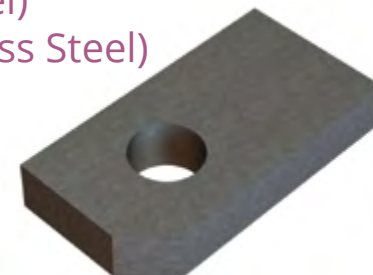
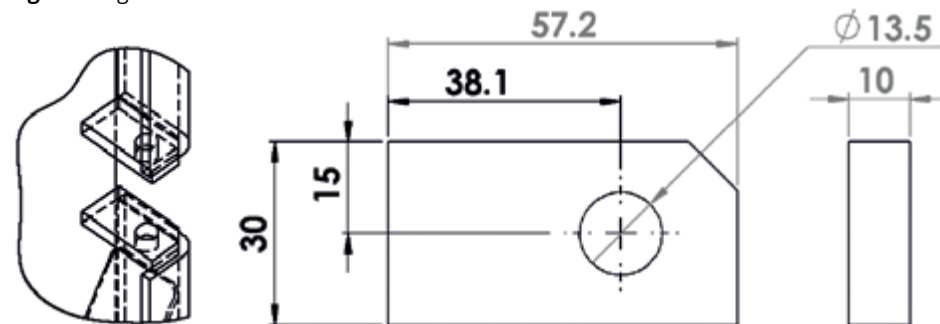

Model No **BCP11354** (Mild Steel)
Model No **BCSP11354#** (Stainless Steel)
Hinge Butt (standard)

Supplied in: Self colour

Use: On with all Bloxwich hinges, commonly used on containers. Other sizes available on request. #Subject to quantity and lead time

Weight: 114 g

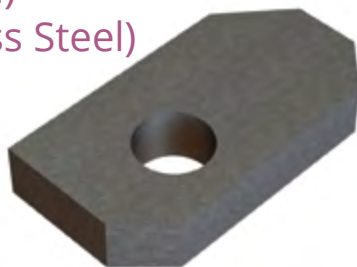
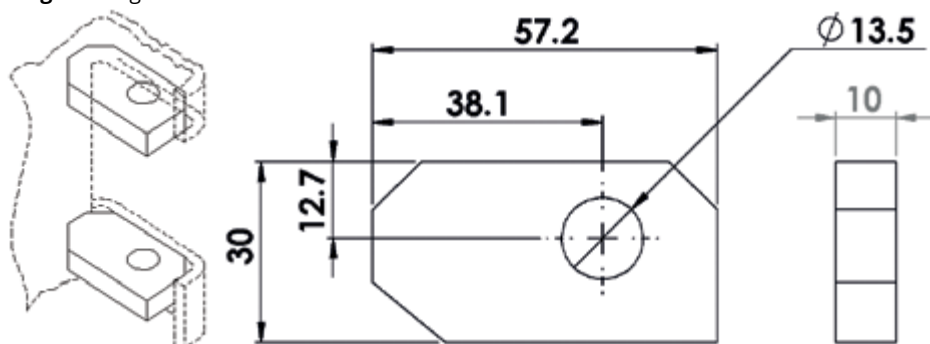

Model No **BCP19200-005** (Mild Steel)
CIMC Container Hinge Butt

Supplied in: Mild steel self colour

Use: Pivot hole size to suit Ø12mm hinge pin. Can be used on any Bloxwich forged or pressed hinge. Designed to be slotted into formed corner posts, tapered inside face for greater door seal clearance. Other sizes available on request

Weight: 68 g

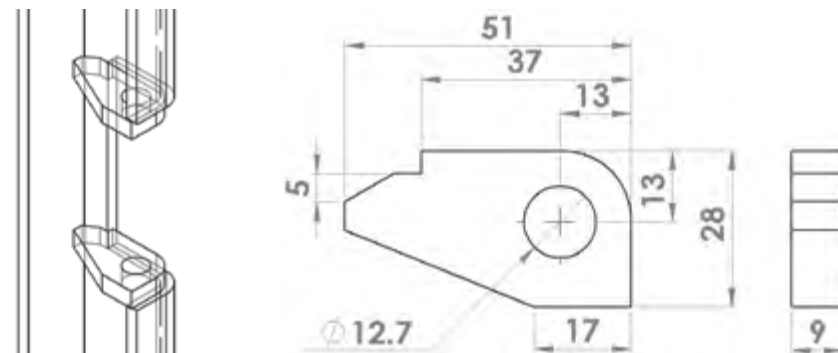

Model No BCP16053 (Mild Steel) Hinge Butt Heavy Duty

Supplied in: Mild steel self colour

Use: Pivot hole size to suit M20 bolt or Ø20 hinge pin.

Weight: 213 g

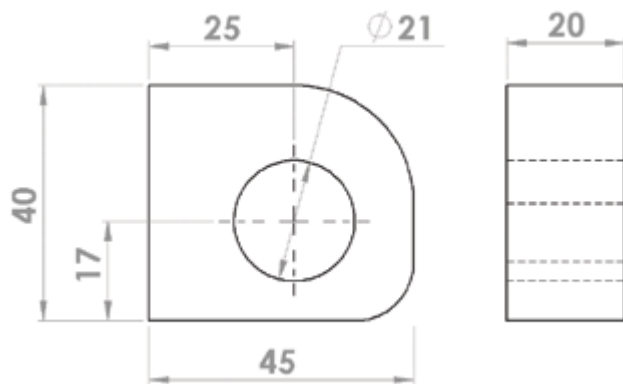
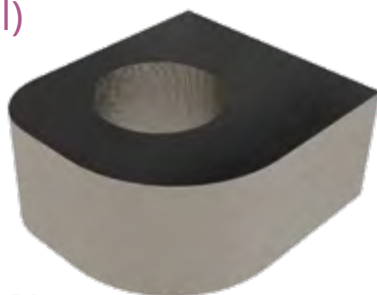

Model No BCP16051-002 (Mild Steel) Heavy Duty Weld On Hinge Bracket

Supplied in: Forged steel self colour or zinc plated

Use: Pivot hole size to suit M20 bolt or Ø20 hinge pin.

Weight: 1.1 kg

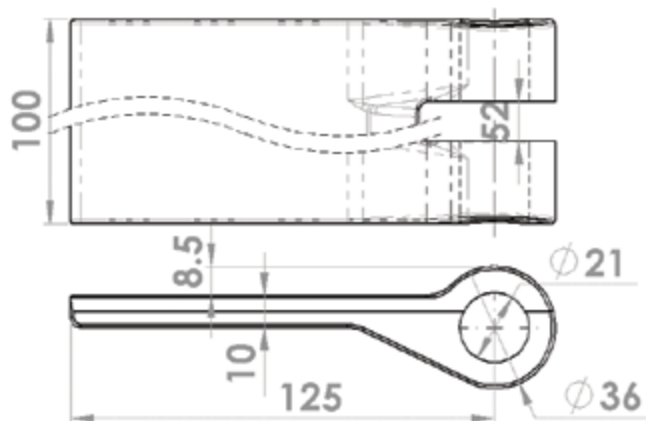

Model No BCP16051-005 (Mild Steel) Heavy Duty Weld On Hinge Bracket

Supplied in: Mild steel self colour

Use: Pivot hole size to suit M20 bolt or Ø20 hinge pin.

Weight: 315 g

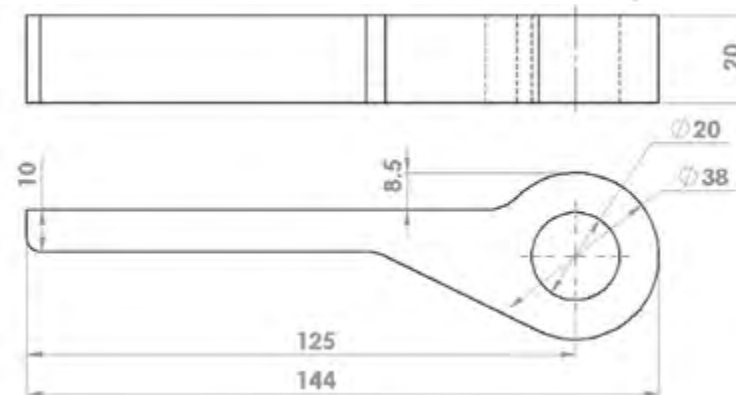

Aluminium, Mild Steel & Stainless Steel Fabrication

At Bloxwich we manufacture a large range of forged, pressed, stamped and injection moulded products constantly. However lots of those products then form larger assemblies that require welding, finishing, assembly and packaging.

Got a fabrication that would benefit from subcontract? The Bloxwich aluminium, mild steel and stainless steel equipment and skills can help.

For more information please call +44 (0)1543 435 160 or email sales@bloxwichgroup.com



Model No BCSP Hinge Pins

Supplied in: 304 stainless steel*

Other pin lengths and diameters available, please contact us

Use: Crimped & grooved pins are used with bloxwich hinges, butts and brackets and E clips. Grooved pins are used with BCSP12336 collars and BCSP14164 E clips to fit hinges. Plain pins are used on welded hinge assemblies where both ends are welded or have BCSP12336 collars fitted. *BCSP12272/94 is 316SS.

Weight: See table

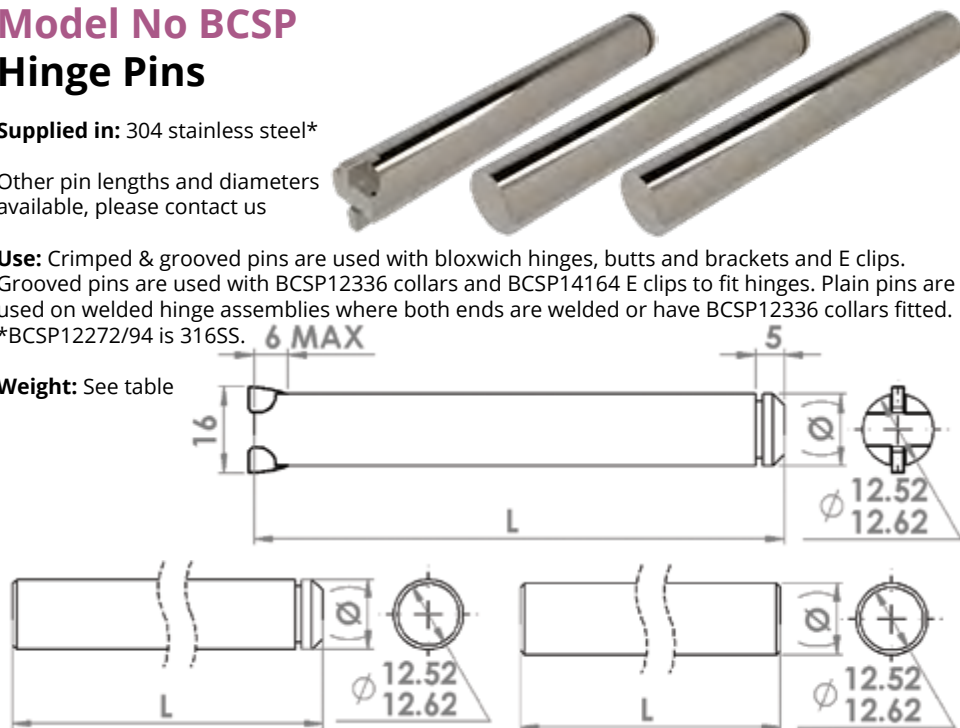

Part No	(Ø)	L	Type	Commonly Used With	Weight
BCSP14163	12	92	Crimped & grooved	64mm brackets & butts	82 g
BCSP12225/94	12.7	94	Crimped & grooved	64mm brackets & butts	94 g
BCSP12225/139	12.7	139	Crimped & grooved	BCP13020Z	135 g
BCSP-24001/92	12	92	Grooved	Various	83 g
BCSP12273/94	12.7	94	Grooved	Bloxwich barrel hinges & various	94 g
BCSP12273/139	12.7	139	Grooved	Various	140 g
BCSP-24001/82	12	82	Plain	Various	83 g
BCSP-24001/94	12	94	Plain	Various	85 g
BCSP-24001/95	12	95	Plain	Various	86 g
BCSP-24001/107	12	107	Plain	BCP18029 & BCP18030	97 g
BCSP12272/82	12.7	82	Plain	Bloxwich forged hinge assy's	83 g
BCSP12272/94*	12.7	94	Plain	BCP1008, BCP18027 & BCP18028	95 g
BCSP12272/107	12.7	107	Plain	Various	108 g
BCP16051-003	20	101	Plain	BCP16051 hinges	254 g

Model No BCSP14164 E Clip

Supplied in: 304 stainless steel

Use: With Bloxwich hinge pins BCSP12225/94, BCSP14163, BCSP12273/94 and BCSP24001/92

Weight: 1 g

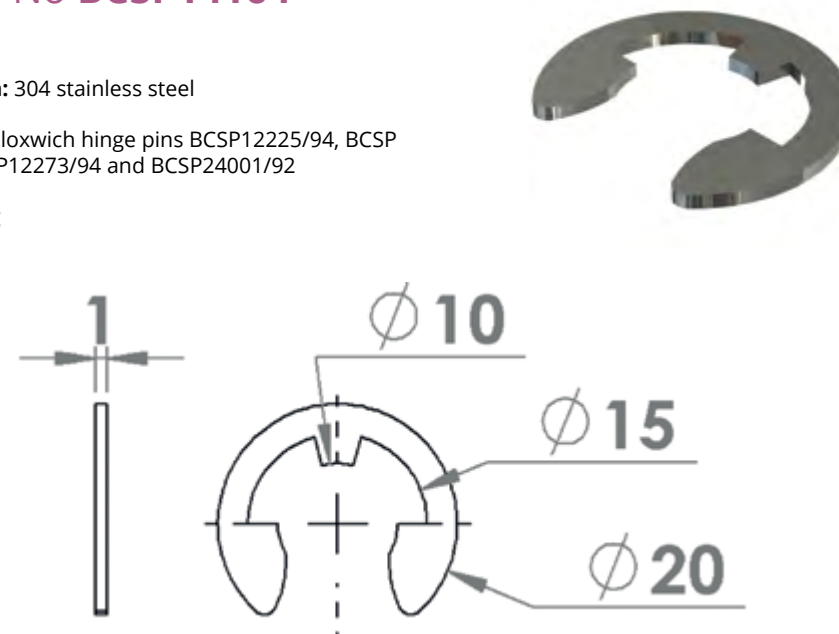

Model No BCSP12336 Hinge Pin Collar

Supplied in: 304 stainless steel

Use: With Bloxwich uncrimped hinge pins, /20 hole size to suit Ø12 hinge pin or M/20 version suits Ø12.7 hinge pin. Allows free rotation of the pin inside the hinge and hinge butts.

Weight: 13 g



Model No BCP1037 (Mild Steel) Forged Steel Gudgeons

Supplied in: Mild steel self colour

Use: Weld on gudgeons for use with BCP1032 and BCP1054 hinges. Can also be used with other Bloxwich hinges

Weight: 160/200/140 g



Part No	A	B	C	D	E	Weight
BCP1037/002	17.5	12.5	63	47	30	160 g
BCP1037/003	20	16	60	48	30	200 g
BCP1037/010	17.5	12.5	50	50	27	140 g

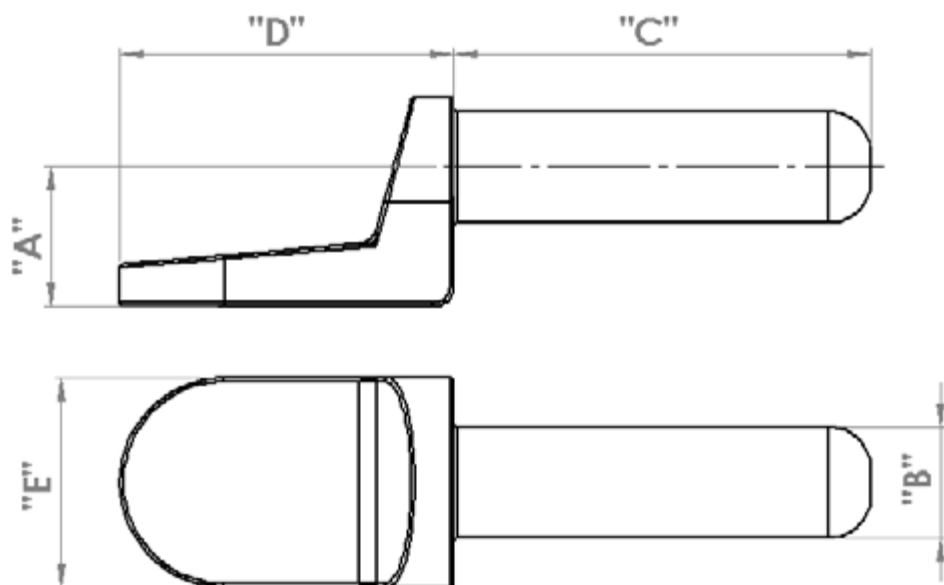

Model No BCP (Mild Steel) Model No BCSP (Stainless Steel) Hinge Bolts

Supplied in: Mild steel zinc plated, galvanised or 304 stainless steel

Use: With Bloxwich hinges, butts and brackets

Weight: See table



Part No	Thread	L	Type	A/F	Weight
BCP12463	M12	100	Mild steel zinc plated	19	96 g
BCP12463/G	M12	100	Mild steel galvanised	19	96 g
BCSP12463	M12	100	304 stainless steel	19	96 g
BCP15125	M12	110	Mild steel zinc plated	19	113 g
BCP15125/G	M12	110	Mild steel galvanised	19	113 g
BCSP15125	M12	110	304 stainless steel	19	113 g
BCSP21005	1/2-13 UNC	89 (3 1/2")	304 stainless steel	19 (3/4")	110 g
BCSP15120	1/2-13 UNC	114 (4 1/2")	304 stainless steel	19 (3/4")	134 g
BCSP15121	1/2-13 UNC	114 (4 1/2")	304 stainless steel, *drilled as required	19 (3/4")	134 g
BCSP15154	1/2-13 UNC	127 (5")	304 stainless steel	19 (3/4")	147 g
BCSP15155	1/2-13 UNC	127 (5")	304 stainless steel, *drilled as required	19 (3/4")	147 g
BCP16054	3/4-10 UNC	127 (5")	Mild steel zinc plated	29 (1 1/8")	390 g
BCP16054/G	3/4-10 UNC	127 (5")	Mild steel galvanised	29 (1 1/8")	390 g
BCSP16054	3/4-10 UNC	127 (5")	304 stainless steel	29 (1 1/8")	390 g

Model No BCP (Mild Steel) Model No BCSP (Stainless Steel) Hinge Nuts

Supplied in: Mild steel zinc plated, galvanised or 304 stainless steel

Use: With Bloxwich hinges, butts and brackets

Weight: See table

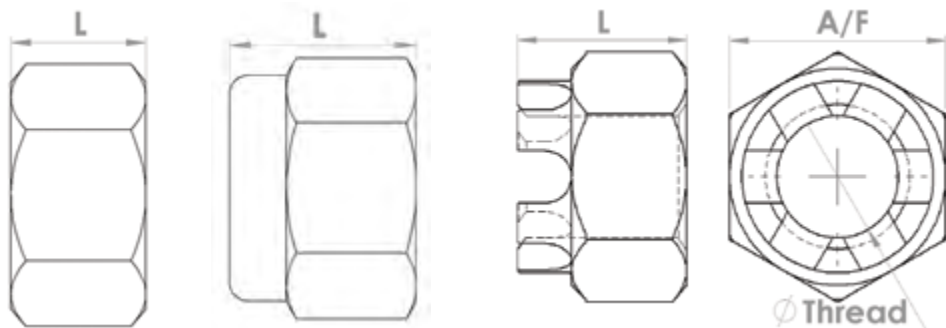

Part No	Thread	L	Type	A/F	Weight
BCP12462	M12	15	Mild steel zinc plated nyloc nut	19	21 g
BCP12462/G	M12	15	Mild steel galvanised nyloc nut	19	21 g
BCSP12462	M12	15	304 stainless steel nyloc nut	19	21 g
BCSP21006	1/2-13 UNC	11	304 stainless steel hex nut	19 (3/4")	19 g
BCSP18012	1/2-13 UNC	15	304 stainless steel nyloc nut	19 (3/4")	21 g
BCSP15128	1/2-13 UNC	15	304 stainless steel castle nut	19 (3/4")	20 g
BCP16055	3/4-10 UNC	22	Mild steel zinc plated nyloc nut	29 (1 1/8")	72 g
BCP16055/G	3/4-10 UNC	22	Mild steel galvanised nyloc nut	29 (1 1/8")	72 g
BCSP16055	3/4-10 UNC	22	304 stainless steel nyloc nut	29 (1 1/8")	72 g

Model No BCSP 15127 Ø2.5 x 25 Cotter Pin

Supplied in: 304 stainless steel

Use: With Bloxwich hinges, butts and brackets. Can be used with 1/2" UNC bolt and castle nut to lock the pin securely but also allows easy removal for maintenance.

Weight: 1 g

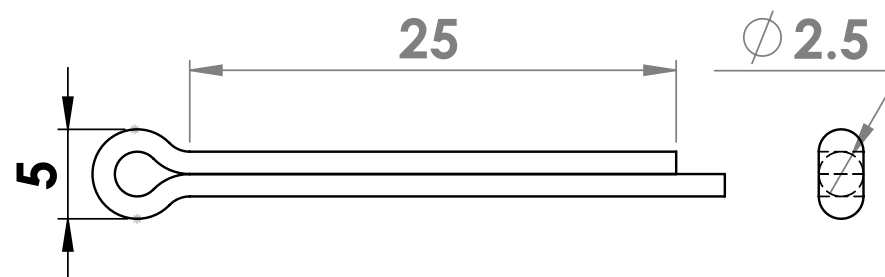

Model No BCP12595 (Mild Steel) Model No BCSP12595 (Stainless Steel)

Grease Nipples

Supplied in: Mild steel zinc plated or 304 or stainless steel. 316 stainless steel also available (BCSP12596)

Use: With Bloxwich hinges.

Weight: 5 g

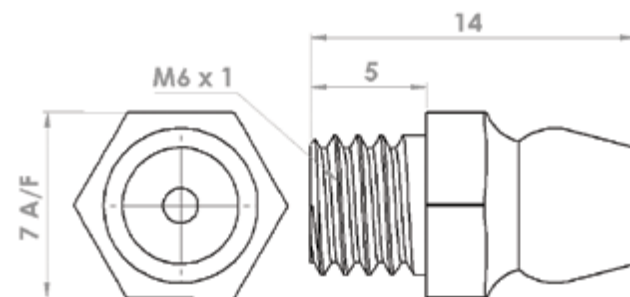

Model No BCSP15133 ½" UNC Flat Washer

Supplied in: 304 stainless steel

Use: With Bloxwich hinges, butts and brackets.

Reduces paintwork damage on assembly.

Weight: 3 g

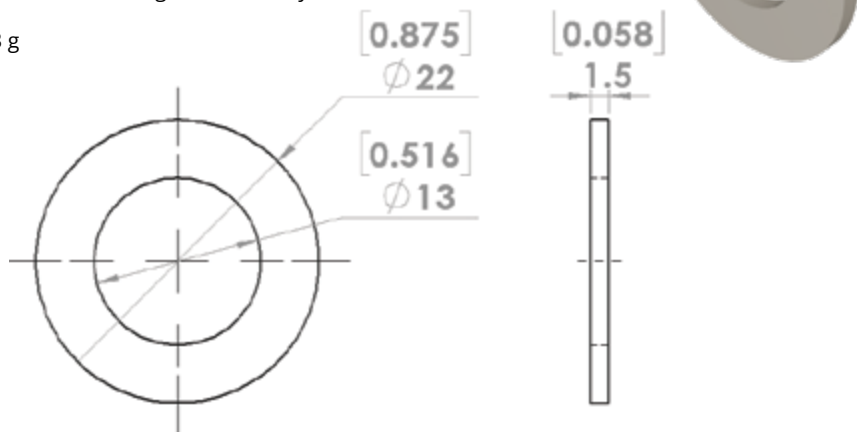

Model No BCSP19067 Hinge Brass Washer

Supplied in: Brass

Use: Can be used anywhere but are commonly used with Bloxwich hinges, pins, bolts and butts or brackets.

Fitted on the underside of hinges as a spacer to prevent wear, paint damage and corrosion in use.

They also increase security by reducing/eliminating gaps between hinges and hinge brackets/butts which makes cutting of the hinge pins/bolts more difficult (if thieves attempt to cut through the washers instead, they can spin on the pin/bolt which again makes cutting more difficult)

Weight: 4 g

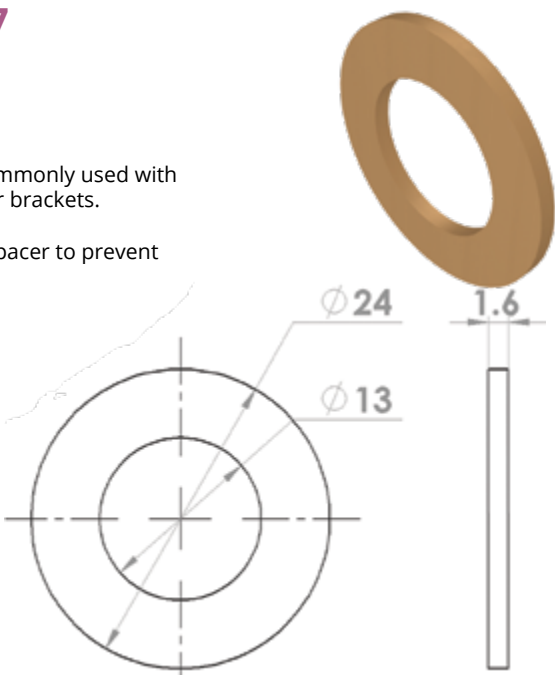

Hinge & Hinge Bracket Gaskets

Supplied in: 1mm EPDM rubber (black)

Use: With Bloxwich hinges to prevent 'in service' abrasion with the door surface, and possible 'galvanic' corrosion encountered when some dissimilar materials are in direct contact with each other.

Others sizes available on request

Weight: see table



Model	Length	Width	No of Holes & Ø	Use with Hinges	Weight
BCP13624E	205	92	4/10.5	BCP10045	26 g
BCP19029E	159	92	3/8.5	BCP12594 & BCSP12171	26 g
BCP20095E	159	84	4/10.5	BC(S)P15073	16 g
BCP20096E	187	74	3/10.5	BC(S)P13607	12 g
BCP20097E	230	94	6/10.5	BC(S)P12447	25 g

Model	Length	Width	No of Holes & Ø	Use with Hinge Bracket	Weight
BCP20101E	132	28	2/10.5	BC(S)P14149	5 g